



Equipped with AEM® Dryflow™ Filter
No Oil Required!

INSTALLATION INSTRUCTIONS

PART NUMBER: 21-9113

2004-2006	FORD	F250 Harley Davidson Super Duty	V8-6.0L DSL	C.A.R.B. E.O. D-392-29
2004-2006	FORD	F250 Super Duty	V8-6.0L DSL	C.A.R.B. E.O. D-392-29
2004-2006	FORD	F350 Harley Davidson Super Duty	V8-6.0L DSL	C.A.R.B. E.O. D-392-29
2004-2006	FORD	F350 Super Duty	V8-6.0L DSL	C.A.R.B. E.O. D-392-29
2004-2006	FORD	F450 Super Duty	V8-6.0L DSL	C.A.R.B. E.O. D-392-29
2004-2006	FORD	F550 Super Duty	V8-6.0L DSL	C.A.R.B. E.O. D-392-29
2004-2005	FORD	Excursion	V8-6.0L DSL	SEE * NOTE

PARTS LIST:

Description	Qty.	Part Number
A Element Parts Kit 4.00x 9" DSL Oval Dry	1	21-2259DK
B Inlet Pipe, 03-06 Ford 6.0L	1	2-81131
C Hose, Silicone 4.00x2" Black	1	5-402
D Insert, Diesel A/F Assy 4"	1	5-2259
E Stand, Aluminum	1	2-670
F Wrench; Torx T20 T/R, L-Key	1	69801
G Grommet, 1/2" 3/32	1	784646
H Grommet, 7/16"	1	784632
I Block Off Plate, 2-688 MAF	1	2-783
J Gasket, Block Off Plate	1	2-7831
K Bolt, Hex M6-1 X 35mm	1	1-2002
L Bolt, Socket M4-.7 X 8mm	2	1-2105
M Washer; 1"D X 1/4 Hole Fender	2	08160
N Nut, M6 Hex Serrated	1	444.460.04
O 1/2" Bnd. Hose Clamp, 3.56"-4.50"	3	9464

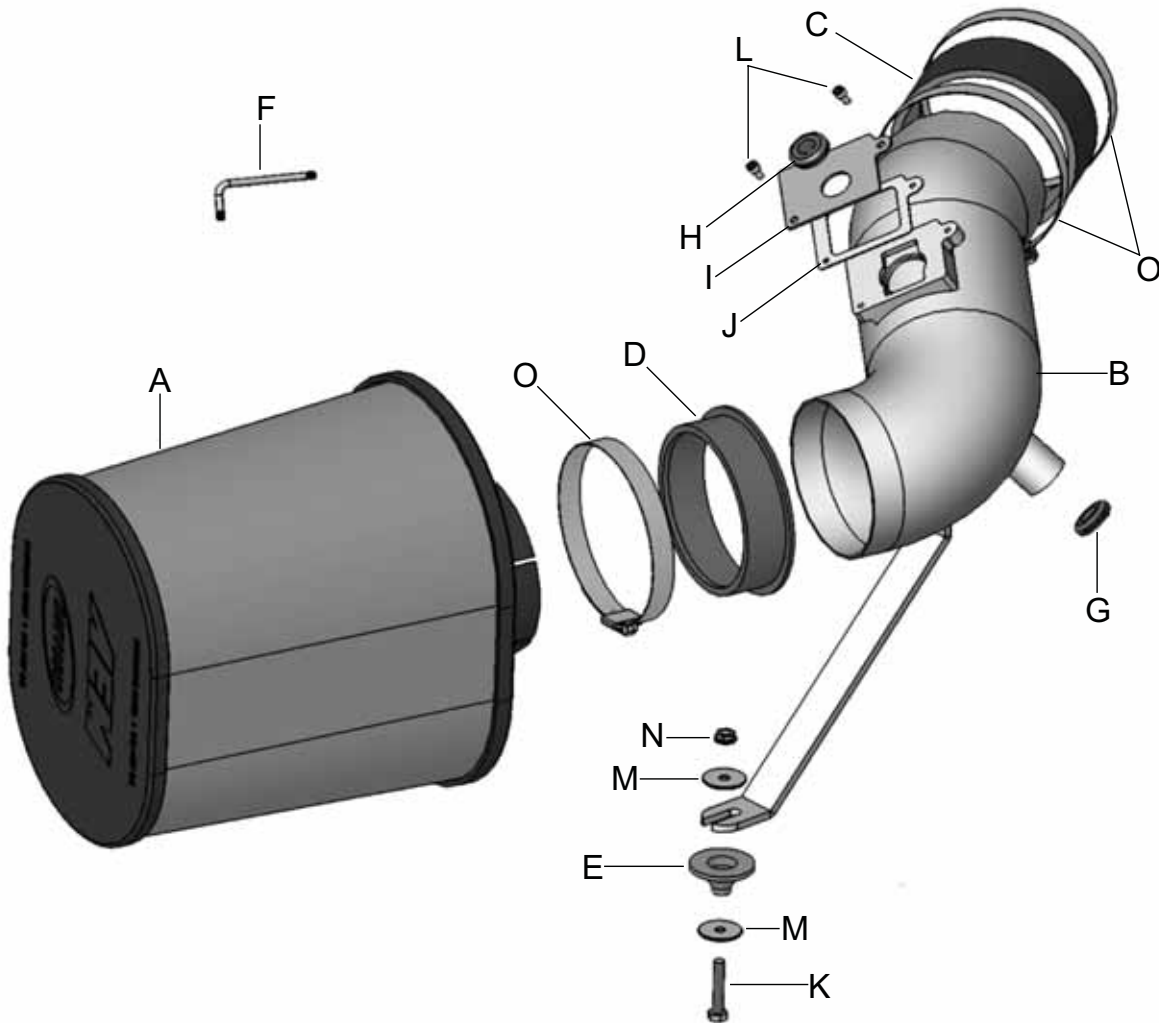

Read and understand these instructions **BEFORE** attempting to install this product. Failure to follow installation instructions and not using the provided hardware may damage the intake tube, throttle body and engine.

1. Preparing Vehicle

- a. Make sure vehicle is parked on level surface.
- b. Set parking brake.
- c. If engine has run in the past two hours, let it cool down.
- d. Disconnect negative battery terminal.
- e. Do not discard stock components after removal of the factory system.

2. Removal of stock system



a. Stock intake system. Unplug the wiring harness from the inlet air temperature (IAT) sensor or mass air flow (MAF) sensor. All vehicles have one or the other.



b. Loosen the hose clamps securing the flexible inlet hose between the turbo inlet and the air filter housing. Remove the hose.



c. Unplug the wiring harness from the air filter restriction gauge. Remove the gauge from the rear of the air filter housing.



d. Unclasp the retaining clips holding the back side of the air filter housing together. Remove the rear side of the air filter housing by lifting up and pulling it out of the engine bay.



e. Pull up and remove the air filter housing from the engine bay.



f. Remove the factory IAT sensor or MAF sensor from the stock air filter housing.

3. Installation of AEM® intake system.

- a. When installing the intake system, do not completely tighten the hose clamps or mounting hardware until instructed to do so.
- b. Before installing intake pipe be sure to check for packaging material in the intake pipe.



c. Factory air box system removed.



d. On vehicles with a MAF sensor, install the sensor into the intake pipe using the two factory bolts removed in step 2f). If your vehicle is equipped with an IAT, skip to step 3e).



e. On vehicles with an IAT sensor, install provided adapter plate onto the intake pipe using the two supplied bolts. Install the supplied grommet into the plate.



f. Install the IAT sensor into the grommet on the adapter plate as shown.



g. Install the silicone coupler onto the turbo inlet and secure using two #64 hose clamps.

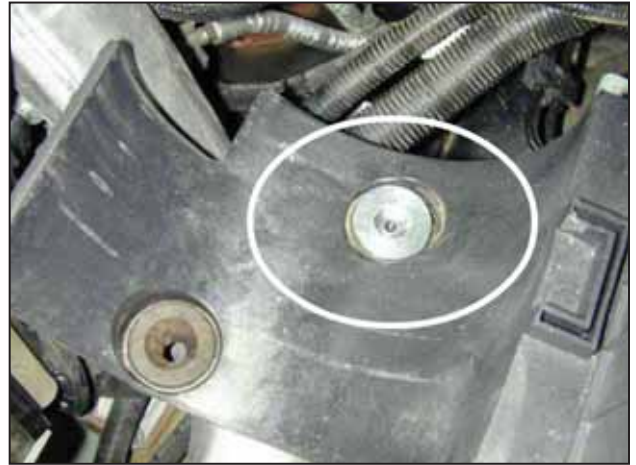

h. Install the billet aluminum stand into the rear rubber mount where the factory air box was removed.



i. Install the intake pipe into the coupler on the turbo inlet. Align the intake pipe mounting bracket with the previously installed aluminum stand. Use a #64 hose clamp to secure.



j. Install the supplied M6 washer and bolt through the bottom of the aluminum stand. Secure the bolt using another M6 washer and serrated nut as illustrated in step 3k.

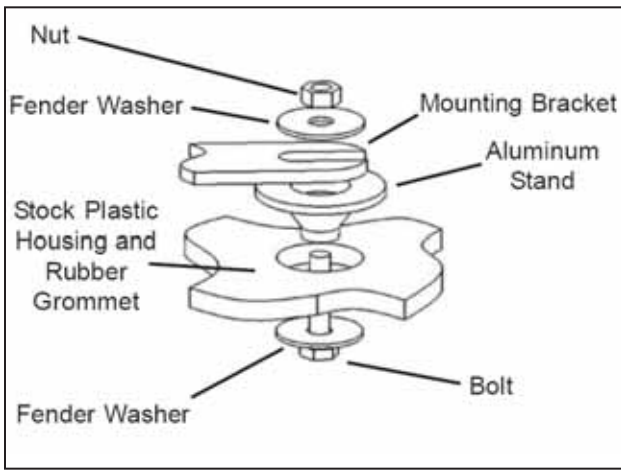

k. Diagram for mounting bracket. Once aligned properly, fully tighten the nut.



l. Install the supplied air filter adapter by stretching it over the filter end of the intake pipe.



m. Slide the hose clamp onto the air filter's neck and attach the air filter assembly onto the filter adapter. Ensure the air filter is completely seated onto the adapter and the hose clamp is aligned with the filter adapter's lip. Once the hose clamp is properly aligned, secure the hose clamp, ensuring the filter neck's tabs compress and engage.



n. Ensure the air filter does not make contact with any part of the vehicle and has adequate clearance.



o. Depending on application, connect the wiring harness plug into the MAF or IAT sensor. Rotate the oil dipstick to allow sufficient clearance.



p. Plug the air filter restriction gauge into the wiring harness. Ensure the wiring harness will not make contact with any components that will get HOT.



Factory air box system installed



AEM® intake system installed

4. Reassemble Vehicle

- Position the inlet pipes for the best fitment. Be sure that the pipes or any other components do not contact any part of the vehicle. Tighten the rubber mount, all bolts, and hose clamps.
- Check for proper hood clearance. Re-adjust pipes if necessary and re-tighten them.
- Inspect the engine bay for any loose tools and check that all fasteners that were moved or removed are properly tightened.
- Reconnect the negative battery terminal and start engine. Let the vehicle idle for 3 minutes. Perform a final inspection before driving the vehicle.

5. CARB Sticker Placement

- The C.A.R.B. exemption sticker, (attached), must be visible under the hood so that an emissions inspector can see it when the vehicle is required to be tested for emissions. California requires testing every two years, other state may vary.

6. Service and Maintenance

- a. AEM Induction Systems requires cleaning the intake system's air filter element every 100,000 miles. When used in dusty or off-road environments, our filters will require cleaning more often. We recommend that you visually inspect your filter once every 25,000 miles to determine if the screen is still visible. When the screen is no longer visible some place on the filter element, it is time to clean it. To clean, purchase our Synthetic air filter cleaner, part number 99-0624 and follow the easy instructions.
- b. Use window cleaner to clean your powder coated AEM® intake tube.

NOTE: DO NOT USE aluminum polish on powder coated AEM® intake tubes.