



Equipped with AEM® Dryflow™ Filter  
No Oil Required!

# **INSTALLATION INSTRUCTIONS**

## **PART NUMBER**

### **21-753C (Gun Metal Gray Finish)**

---

2015	CHRYSLER	200	2.4L
2016	CHRYSLER	200	2.4L

ITEM NO.	PART NUMBER	DESCRIPTION	QTY.
1	1-113	ZIP TIE,6 LONG	3
2	21781	EXTENSION HARNESS; 44"L IAT	1
3	2-1531C	INTAKE TUBE; 2.75" OD X 38.5", 21-753, GUNMETAL GRAY	1
4	784646	GROMMET, 1/2" 3/32 GW	1
5	20-8550B	HEAT SHIELD; 21-753 CHRYSLER 200	1
6	1-2110	BOLT; HEX/FLANGE M6-1.0 X 12	3
7	8-186	MOUNT, PLASTIC AIRBOX	3
8	9448	1/2" BNDHOSE CLAMP,2.56"-3.50"	1
9	21-2157DK	AIR FILTER 2-3/4" FLG, 5-1/2"B, 4-3/4T DRYFLOW	1
10	444.460.04	NUT; M6 HEX SERRATED	1
11	08275	WASHER; 1/4"ID X 5/8"OD - SAE	1
12	07027	STUD; M6-1.00 M/M, RUBBER MNTD	1
13	08553	HOSE CLAMP; SPRING BAND 20MM	1
14	1-127	ZIP TIE,8" TREE PUSH-MNT	1
15	9444	HOSE CLAMP, 2.31-3.25"	2
16	5-272	HOSE, SILICONE 2.75X2" BLACK	1
17	102471	EDGE TRIM; 3/4 BULB, TOP LOC, 35"L	1
18	102474	EDGE TRIM; 3/4"BULB; TOP LOC, 15"L	1

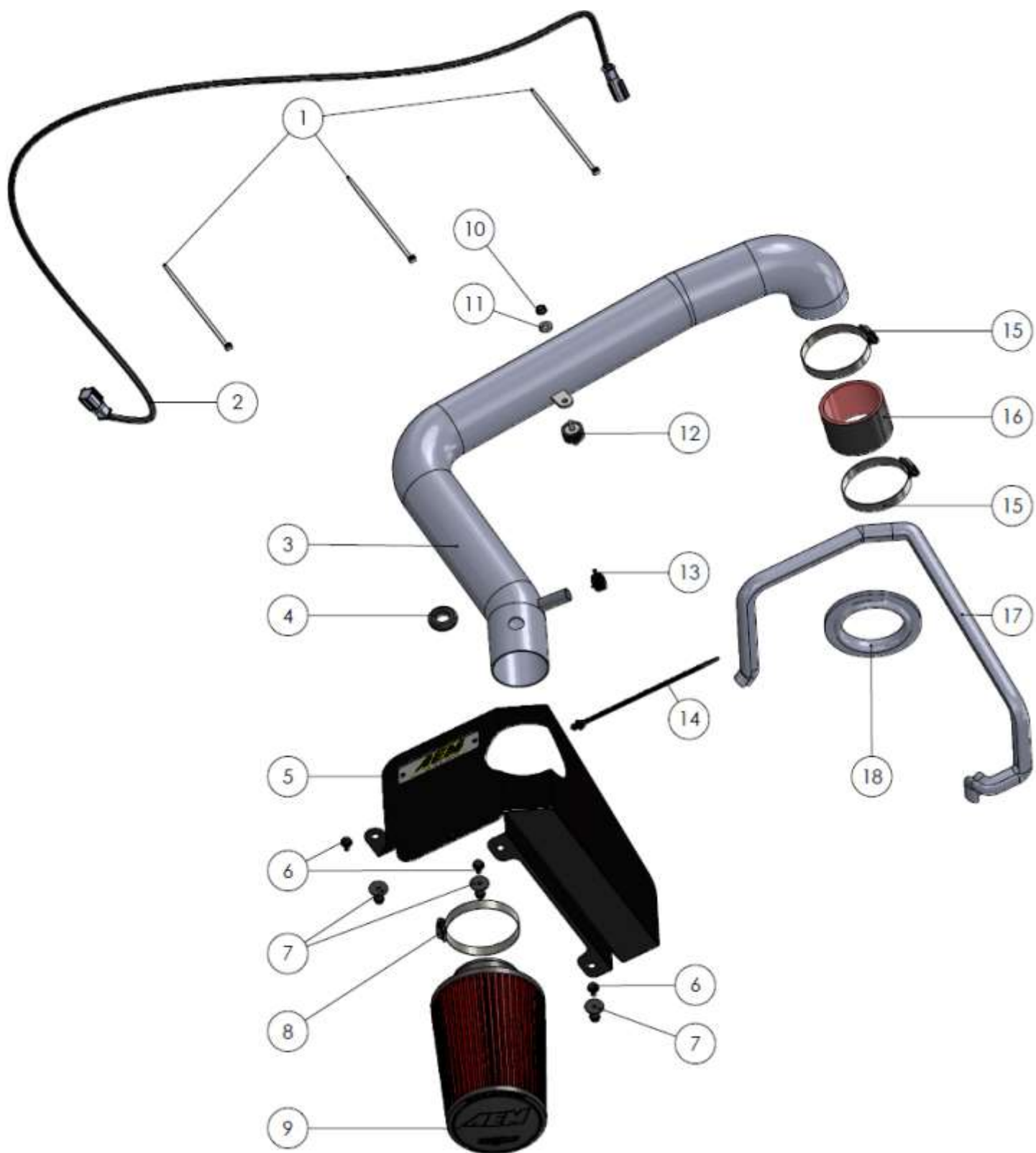

Read and understand these instructions **BEFORE** attempting to install this product. Failure to follow installation instructions and not using the provided hardware may damage the intake tube, throttle body and engine.

## 1. Preparing Vehicle

- a. Make sure vehicle is parked on level surface.
- b. Set the parking brake.
- c. If engine has run in the past two hours, let it cool down.
- d. Disconnect negative battery terminal.
- e. Do not discard stock components after removal of the factory system.
- f. Open the air intake kit package and make sure all parts are included.

### Tools Needed:

Screwdriver

Socket Driver

7mm, 8mm, 10mm sockets

Pliers

Diagonal Cutters

## 2. Removal of stock system



a. Remove the engine cover by pulling up on all four corners. Engine cover will be re-installed in step 3p.



b. Disconnect the intake temp sensor connector.



c. Loosen the hose clamp at the throttle body.



d. Disconnect the plastic connector, that secures the chamber to the vehicle.



e. Remove the bolt that secures the stock intake tube to the vehicle.



f. Slide the vent tube off of the stock intake tube.



g. Pull straight up on the stock air box and remove it from the vehicle. Note: **Do not** discard any of your stock equipment.



h. Remove the air temperature sensor from the stock intake tube by turning it counter clockwise. This will be re-used in step 3l.



i. Remove the O-ring from the air temperature sensor. Note: the O-ring will not be re-used but **do not** discard.

### 3. Installation of AEM® intake system.

a. When installing the intake system, do not completely tighten the hose clamps or mounting hardware until instructed to do so.



a. Install the extension harness onto the vehicle. Plug one end into the factory connector circled and zip tie the harness to the vehicle where shown.



b. Install the coupler with the two supplied (9444) hose clamps and tighten the one closest to the throttle body.



c. Install the two pieces of edge trim onto the heat shield. Note: Some trimming may be necessary.



d. Install the bolts and air box mounts to the heat shield as shown.



e. Install the heat shield into the vehicle aligning the plastic mounts with the rubber mounts on the vehicle. Pull the harness through the hole at this time.



f. Install the supplied grommet into the AEM intake tube.



g. Slide the AEM intake tube into the heat shield as shown.



h. Align the AEM intake tube with the coupler that was previously installed on the throttle body.



i. Install and tighten the rubber mount onto the engine.



j. Align the AEM tube bracket with the rubber mount and install the washer and nut. Tighten at this time.



k. Tighten the upper hose clamp on the throttle body.



l. Install the air temp sensor that was removed in step 2h into the grommet until the tab touches.



m. Attach the harness connector to the air temperature sensor.



n. Push the (push tree mount) zip tie into the hole on the heat shield and zip tie the harness to the heat shield.



o. Install the stock vent hose onto the AEM tube and secure with the supplied spring clamp.

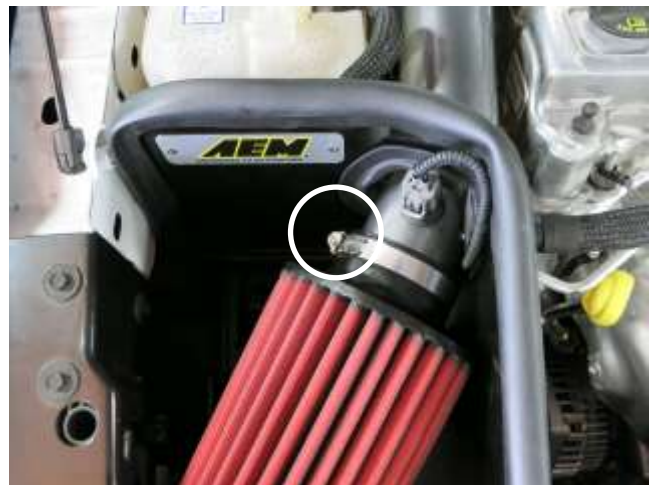

p. Install the AEM filter onto the AEM intake tube and secure with the supplied (9448) hose clamp. Then re-install the engine cover that was removed in step 2a.





STOCK INTAKE INSTALLED



AEM INTAKE INSTALLED

#### 4. Reassemble Vehicle

- a. Position the inlet pipes for the best fitment. Be sure that the pipes or any other components do not contact any part of the vehicle.
- b. Check for proper hood clearance. Re-adjust pipes if necessary and re-tighten them.
- c. Inspect the engine bay for any loose tools and check that all fasteners that were moved or removed are properly tightened.
- d. Reconnect negative battery terminal and start engine. Let the vehicle idle for 3 minutes. Perform a final inspection before driving the vehicle.

#### 5. Service and Maintenance

- a. AEM Induction Systems requires cleaning the intake system's air filter element every 100,000 miles. When used in dusty or off-road environments, our filters will require cleaning more often. We recommend that you visually inspect your filter once every 25,000 miles to determine if the screen is still visible. When the screen is no longer visible some place on the filter element, it is time to clean it. To clean, purchase our Synthetic air filter cleaner, part number 1-1000 and follow the easy instructions.
- b. Use window cleaner to clean your powder coated AEM® intake tube.

**NOTE: DO NOT USE aluminum polish on powder coated AEM® intake tubes.**