



Equipped with AEM® *Dryflow™ Filter*
No Oil Required!

INSTALLATION INSTRUCTIONS

PART NUMBER

21-747C (Gun Metal Gray Finish)

2013	Honda	Accord	2.4L
2014	Honda	Accord	2.4L
2015	Honda	Accord	2.4L

ITEM NO.	PART NUMBER	DESCRIPTION	QTY.
1	2-1524C	TUBE; 2.75"OD X 42"L, AL, HONDA ACCORD 2.4L, 21-747	1
2	AEM-21-2027DK	AIR FILTER	1
3	1228596	MOUNT, RUBBER M6 X 3/4" TALL M/F	1
4	084014	HOSE; 2-3/4" TO 2-5/8" ID X 2" L TPRD REINFORCED	1
5	8-168	ADAPTER, PCV	1
6	08554K	HOSE CLAMP #40, BLACK ZINC PLATED	2
7	08601	HOSE CLAMP #48	1
8	08160	WASHER; 1"D X 1/4 HOLE FENDER	1

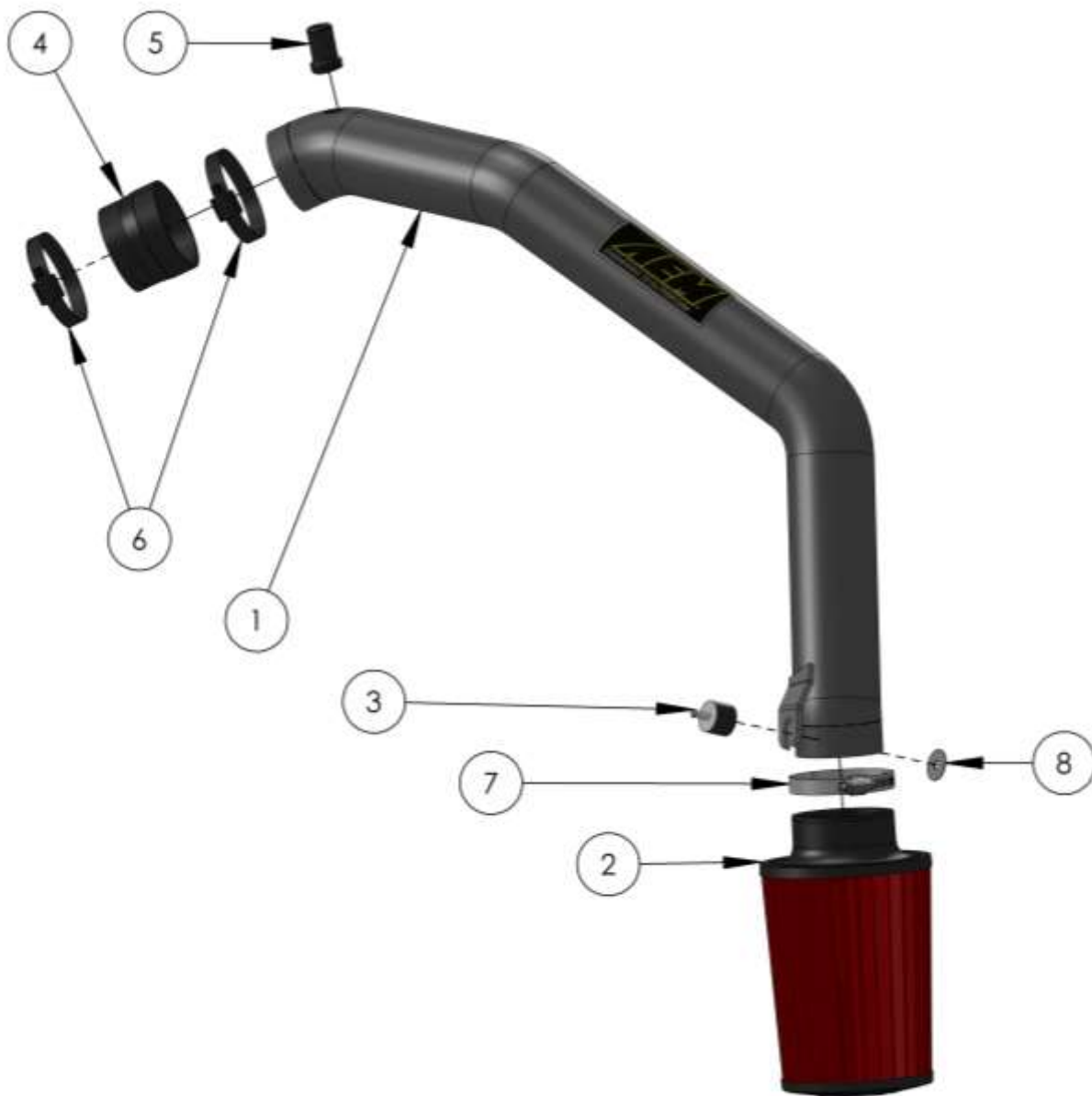

Read and understand these instructions **BEFORE** attempting to install this product. Failure to follow installation instructions and not using the provided hardware may damage the intake tube, throttle body and engine.

1. Preparing Vehicle

- a. Make sure vehicle is parked on level surface.
- b. Set the parking brake.
- c. If engine has run in the past two hours, let it cool down.
- d. Disconnect negative battery terminal.
- e. Do not discard components of the factory system after removal.
- f. Open the air intake kit package and make sure all parts are included.

Tools Needed:	Needle-nosed pliers
Flat & cross screw drivers	10mm wrench
10mm socket	8mm socket
Socket driver with 14" of extension & U-joint	
Torque wrench & 19mm socket (for wheel removal & installation)	Vehicle Jack

2. Removal of stock system



a. Release the green clips retaining the MAF sensor wiring harness and disconnect it from the sensor.



b. Use a cross screw driver or 5.5mm socket to loosen the hose clamp securing the factory intake system to the throttle body. Also remove PCV line from intake boot.



c. Remove the two bolts securing the factory airbox.



d. Pull the factory intake duct off the throttle body and lift it out along with the airbox.



e. Jack vehicle up at a weight bearing location to lift driver-side wheel off the ground, then remove the wheel.

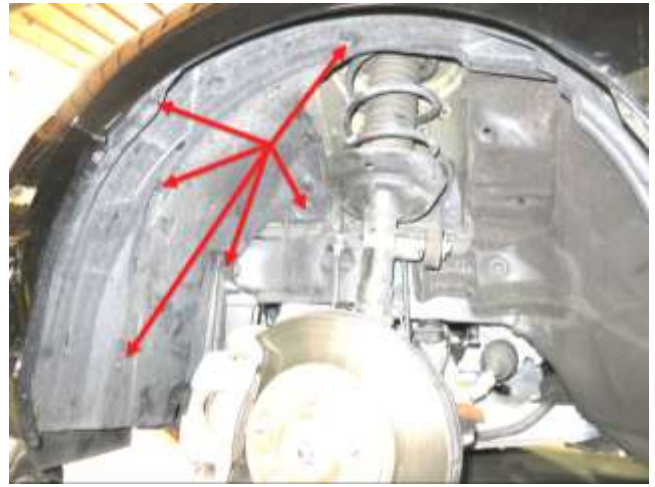

f. Using a flat screw driver, disconnect the nine trim panel clips shown above. Disconnect by inserting screwdriv-



er on both sides, one after the other and twisting until one piece separates from the other. Both pieces of the

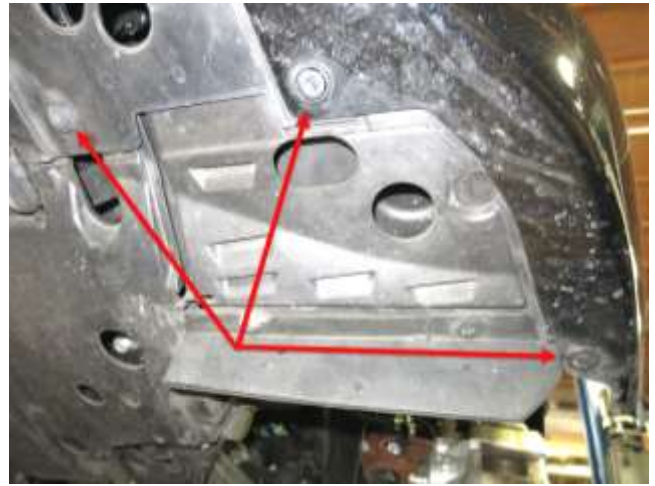

clip can then be pulled out together. Repeat for the three clips in front of the wheel shown above.



g. Separate the undercarriage panel from the fender liner by rotating them away from each other.



h. Once the fender liner is free, it can fold neatly back behind the brake assembly as shown.



i. First remove the bolt shown above on the left, allowing you to lower the resonator. Using a short 10mm socket and u-joint on the end of at least 14" of exten-



sion, remove the bolt on the right. The resonator can then be pulled out as shown above.

3. Installation of AEM® intake system.

- a. When installing the intake system, do not completely tighten the hose clamps or mounting hardware until instructed to do so.



a. Remove the bolt securing the above bracket and replace it with the included rubber mount. Loosely reinstall the bolt with the included washer.



b. Install the included coupler and black hose clamps as shown on the throttle body.



c. Remove the MAF sensor from the factory intake system and install it in your new AEM intake tube with the factory hardware. Also install the rubber tube adapter in the hole at the opposite end of the tube.



d. Lower the tube down into the engine bay. Insert the tube bracket between the rubber mount & the washer. Slide other end into the coupler & tighten the clamps.



e. Tighten the bolt at the bracket end of the tube with an end wrench.



g. Connect the MAF sensor and install the air filter. Install the PCV tube into the adapter at the other end of the tube and seat fully. Reinstall the fender liner and check for clearance at the end of the filter and around the upper edge. If the filter displaces the fender liner, loosen the clamps and bolt, adjust and re-tighten. Reinstall the wheel, taking care to properly torque the wheel to factory specifications.



h. Factory air induction system.



i. Finished installation of AEM Intake System.

4. Final Procedure

- a. Inspect the engine bay for any loose tools and check that all fasteners that were moved or removed are properly tightened.
- b. Reconnect negative battery terminal and start engine. Let the vehicle idle for 3 minutes. Perform a final inspection before driving the vehicle.

5. Service and Maintenance

- a. AEM Induction Systems requires cleaning the intake system's air filter element every 100,000 miles. When used in dusty or off-road environments, our filters will require cleaning more often. We recommend that you visually inspect your filter once every 25,000 miles to determine if the screen is still visible. When the screen is no longer visible some place on the filter element, it is time to clean it. To clean, purchase our Synthetic air filter cleaner, part number 1-1000 and follow the easy instructions.
- b. Use window cleaner to clean your powder coated AEM[®] intake tube.

NOTE: DO NOT USE aluminum polish on powder coated AEM[®] intake tubes.