



Equipped with AEM® *Dryflow™ Filter*
No Oil Required!

INSTALLATION INSTRUCTIONS

PART NUMBER: 21-736C (Gun Metal Grey Finish)

2011-2014	Kia	Optima	2.4L
2011-2014	Hyundai	Sonata	2.4L

ITEM NO.	PART NUMBER	DESCRIPTION	QTY.
1	9448	1/2" BNDHOSE CLAMP,2.56"-3.50"	2
2	5-302	HOSE, SILICONE 3.00X2" BLACK	1
3	080022	VENT; STRT 1/2" HOSE, 1/4"NPT	1
4	5-5010	HOSE; 1/2"ID X 10"L	1
5	5-1015	HOSE; 3/8"ID X 15"L	1
6	08032	PLUG; 1/4 NPT, PLASTIC, BLACK	1
7	08047	VENT; STRT, 3/8"HOSE, 1/4"NPT,	1
8	20-8529	HEAT SHIELD; 21-736 MILD STL TB/PC	1
9	444.460.04	NUT; M6 HEX SERRATED	1
10	08160	WASHER; 1"D X 1/4 HOLE FENDER	1
11	1228599	MOUNT, RUBBER 1" X 6MM	1
12	2-1473	Intake Tube; 21-736 Optima/Sonata 2.4L	1
13	9452	1/2" BNDHOSE CLAMP,2.90"-3.75"	1
14	21-203DD	ELEMENT PARTS KIT 3.00 X 5" DRY	1
15	1-2038	BOLT; HEX/FLANGE M6-1 X 20	2

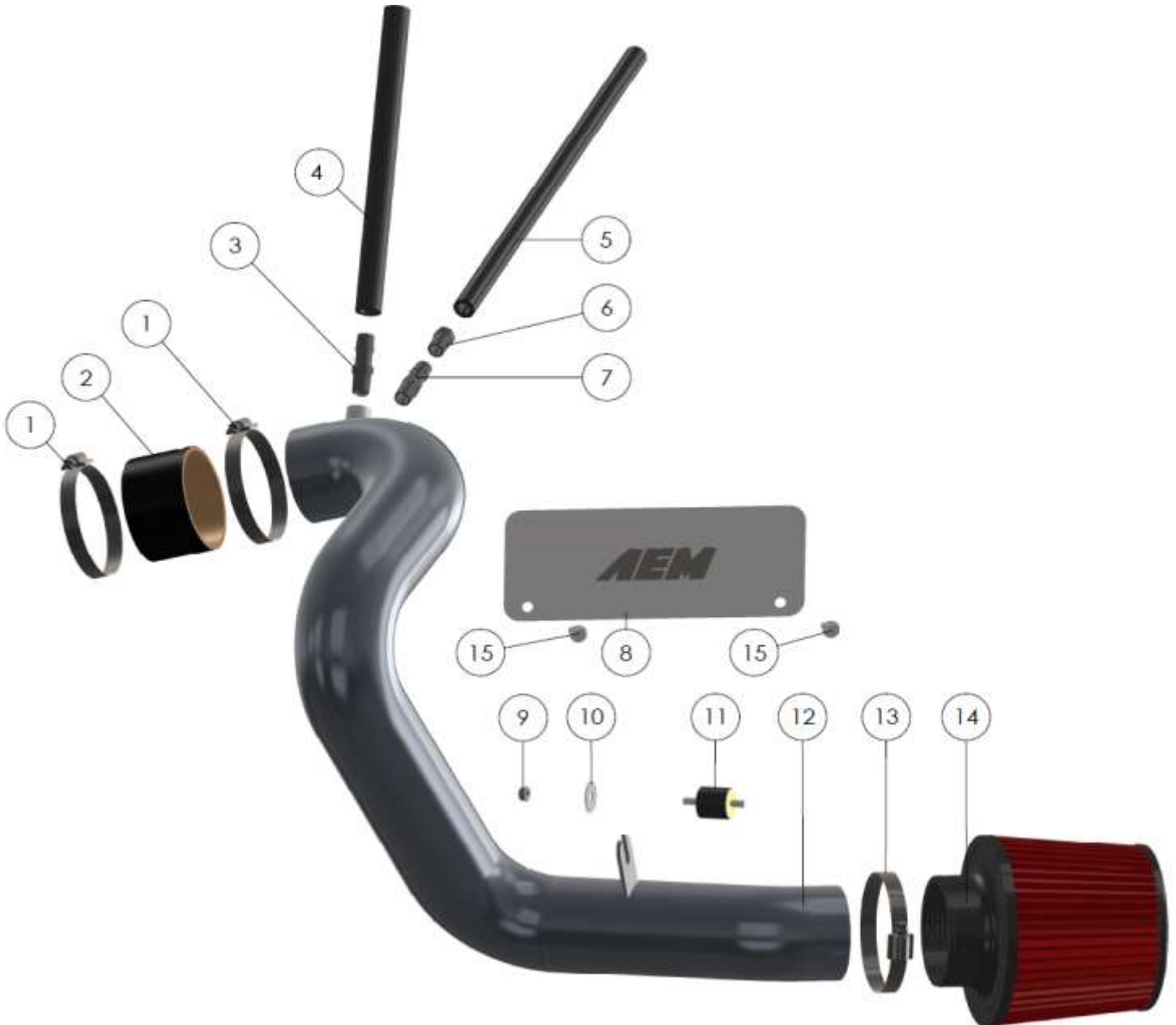

Read and understand these instructions **BEFORE** attempting to install this product. Failure to follow installation instructions and not using the provided hardware may damage the intake tube, throttle body and engine.

Tools Needed:

- Screw driver
- 10MM socket
- Socket Driver
- Pliers

1. Preparing Vehicle

- a. Make sure vehicle is parked on level surface.
- b. Set the parking brake.
- c. If engine has run in the past two hours, let it cool down.
- d. Disconnect negative battery terminal.
- e. Do not discard stock components after removal.
- f. Open the air intake kit package and make sure all parts are included.

2. Removal of stock system



a. Remove the engine cover by pulling up and out of the vehicle. Remove the two bolts holding the air scoop to the vehicle and remove the scoop.

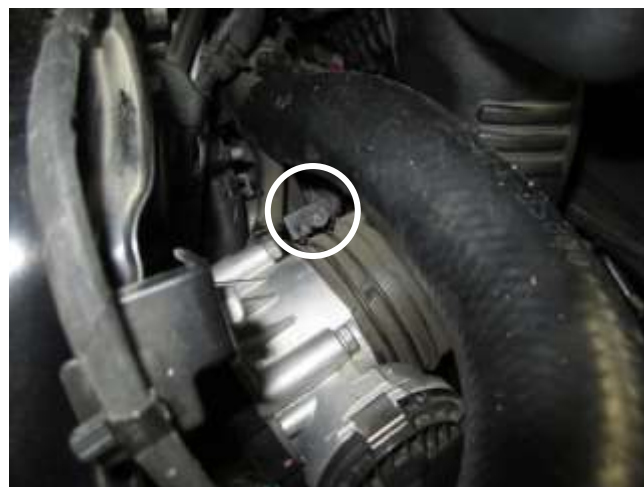

b. Loosen the hose clamp at the throttle body.



c. Loosen the hose clamp at the air box.



d. Loosen the #1 pressure clamp and remove the vent tube. On vehicles equipped with an EVAP vent line, disconnect the #2 pressure clamp and remove the EVAP hose from the "T" fitting. All four of the pressure clamps will be re-used in 3f & 3g.

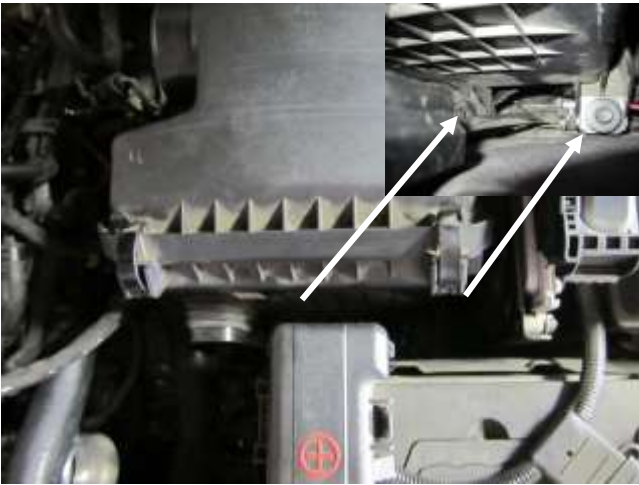

e. Remove the stock intake tube, then remove the two bolts securing the stock air box. **Note:** Do not discard any of your stock equipment.



f. Remove the bolts circled on the drivers side chassis. You will only be reusing the bolt on the right in step 3a.

3. Installation of AEM® intake system.

a. When installing the intake system, do not completely tighten the hose clamps or mounting hardware until instructed to do so.



a. Install the rubber mounted stud into the bolt hole that was removed in step 2f. Combine both ground cables together and tighten the bolt back up.



b. Install the coupler and hose clamp (9448) onto the throttle body and tighten.



c. Install the correct fitting based on your vehicle vent line configuration. On vehicles equipped with an EVAP vent line use the fitting (08047). On vehicles not equipped, use the plug (08032).



d. Slide the tube into the wheel well, align the bracket with the rubber mounted stud. Install/tighten the washer and nut to secure the tube. **Note:** The tube will go between the two flex lines that run to the radiator.



e. Install the tube into the throttle body coupler and tighten the hose clamp. **Note:** Make sure there is clearance between tube and coolant lines.



f. Install the hose (5-5010) and (5-1015) onto the fittings and secure with the pressure clamps that were removed in step 2d.



g. Install the other end of hose (5-5010) onto the valve cover port. Install (5-1015) onto the EVAP vent line. Secure with the pressure clamps removed in step 2d.



h. Remove the 3 screws holding the drivers side splash guard and lower the guard.



i. Place the AEM filter up into the wheel well above the splash guard as shown.



j. Slide the AEM filter onto the tube and tighten the hose clamp (9452). **Note:** Rotate the offset-base filter as necessary to gain best clearance.



k. Install the 3 screws that were removed in step 3h.



l. Install the heat shield onto the front radiator support using the provided bolts (1-2038)



Stock Intake Installed.



AEM Intake Installed.

4. Reassemble Vehicle

- a. Position the inlet pipes for the best fitment. Be sure that the pipes or any other components do not contact any part of the vehicle.
- b. Check for proper hood clearance. Re-adjust pipes if necessary and re-tighten them.
- c. Inspect the engine bay for any loose tools and check that all fasteners that were moved or removed are properly tightened.
- d. Reconnect negative battery terminal and start engine. Let the vehicle idle for 3 minutes. Perform a final inspection before driving the vehicle.

5. Service and Maintenance

- a. AEM Induction Systems requires cleaning the intake system's air filter element every 100,000 miles. When used in dusty or off-road environments, our filters will require cleaning more often. We recommend that you visually inspect your filter once every 25,000 miles to determine if the screen is still visible. When the screen is no longer visible some place on the filter element, it is time to clean it. To clean, purchase our Synthetic air filter cleaner, part number 99-0624 and follow the easy instructions.
- b. Use window cleaner to clean your powder coated AEM[®] intake tube.

NOTE: DO NOT USE aluminum polish on powder coated AEM[®] intake tubes.