



Equipped with AEM® *Dryflow™ Filter*  
No Oil Required!

# **INSTALLATION INSTRUCTIONS**

## **PART NUMBER: 21-702**

---

2012 FORD Focus L4-2.0L SEE \* NOTE

## PARTS LIST

	Description	Qty.	Part Number
A	Upper Pipe	1	2-1478
B	Middle Pipe	1	2-1479
C	Lower Tube	1	2-1480
D	Hose, Hump 2.50/2.75x3.00" EPDM	1	5-1067
E	Hose, Silicone 2.50x3" Blk.	1	5-250
F	Hose, Adapter 3.25/2.75x3" EPDM	1	5-328
G	Element Parts Kit; 2-1/2" Flg.	1	21-2011DK
H	Bracket	1	32-3084
I	Hose Clamp, 2.15-3.00"	4	9440
J	1/2" Bndhose Clamp, 2.90"-3.75"	1	9452
K	Hose Clamp, 2.31-3.25"	4	9444
L	MAF Extension Harness	1	21780
M	Washer; 1"D X 1/4 Hole Fender	1	08160
N	Bolt; Hex/Flange M6-1 X 20	1	1-2038
O	Washer; 4mm Flat	2	08278
P	Bolt, Socket M4-.7 X 20mm	2	1-2103
Q	Zip Tie, 6 Long	2	1-113
R	Hose, Adapter 2.50/2.75 X 3" Bl.	1	5-257

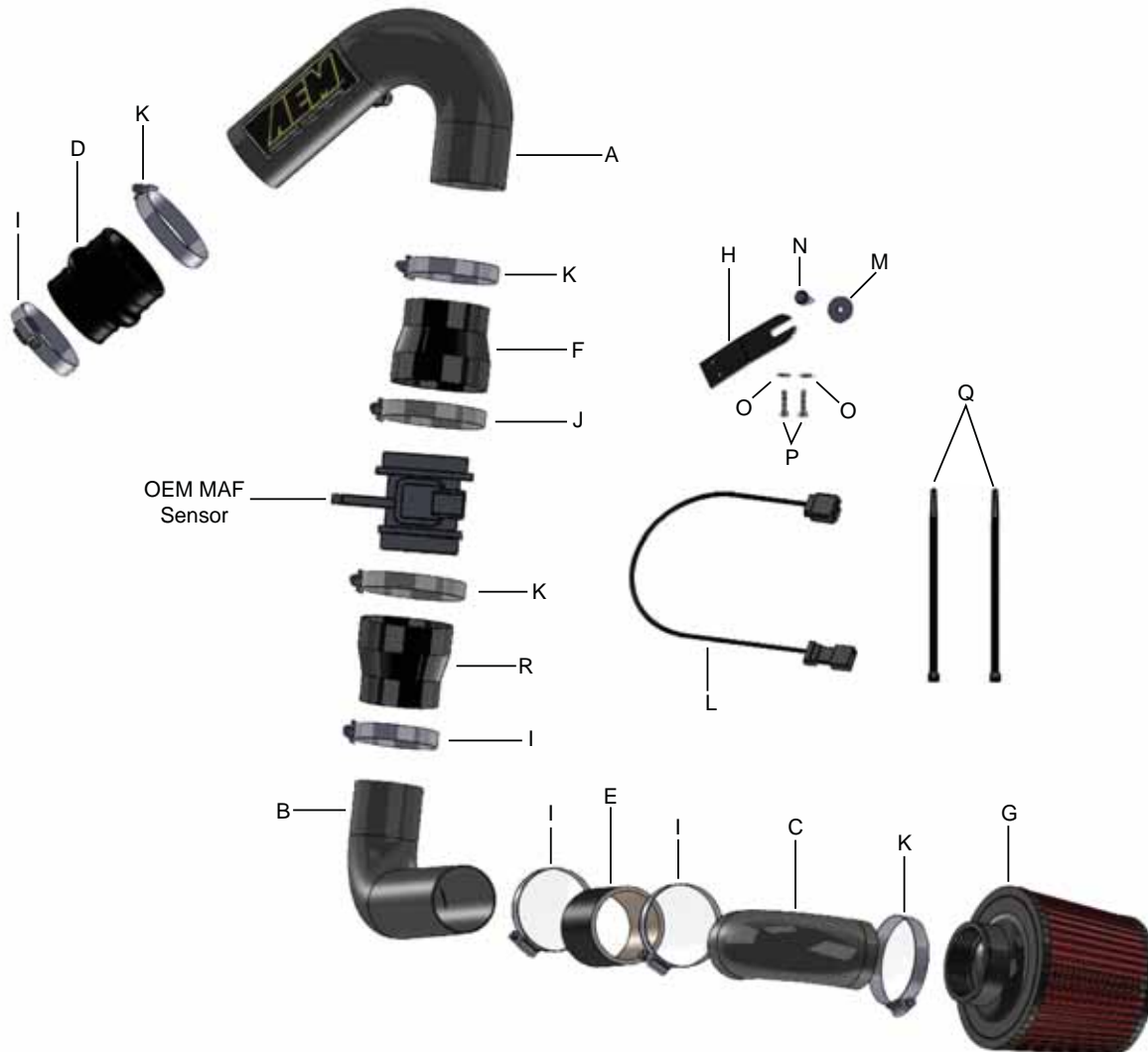

Read and understand these instructions **BEFORE** attempting to install this product. Failure to follow installation instructions and not using the provided hardware may damage the intake tube, throttle body and engine.

The AEM® intake system is a performance product that can be used safely during mild weather conditions. During harsh and inclement weather conditions, you must return your vehicle to stock OEM airbox and intake tract configuration. Failure to follow these instructions will void your warranty.

## 1. Preparing Vehicle

- a. Make sure vehicle is parked on level surface.
- b. Set parking brake.
- c. If engine has run in the past two hours, let it cool down.
- d. Disconnect negative battery terminal.
- e. Raise the front of the vehicle with a jack. Refer to your owner's manual for proper jack and jack stand placement to properly support vehicle. Support your vehicle using properly rated jack stands before wheel removal or while working under the vehicle.  
**NEVER WORK UNDER A VEHICLE WITHOUT USING JACK STANDS.**
- f. Do not discard stock components after removal of the factory system.

## 2. Removal of stock system



a. Loosen the hose clamp that secures the intake tube to the throttle body.



b. Lift up on the red locking clip and unplug the MAF sensor.



c. Unplug the wire harness clip securing the harness to the MAF sensor bracket.



d. Locate PCV hose #1 (Blue locking mechanism) at the top of the intake tube and disconnect the connection as shown.



e. Locate PCV hose #2 (Grey Locking Mechanism) and disconnect from the intake tube.



f. Pull the intake tube off of the throttle body.



g. Unfasten the rubber air inlet strap securing the air box to the front of the vehicle.



h. The air box is mounted to 3 rubber grommets, pull the air box up and out to dislodge the air box from the grommets.



i. Remove the air box assembly from the vehicle.



j. Loosen the hose clamp securing the intake tube to the MAF sensor. Remove the intake tube from the airbox assembly.



k. Remove the two 8mm bolts that secure the MAF sensor to the air box.



l. Use a panel popper or flat screw driver to remove the front cover on the bumper. Place the tool in between the bumper and cover. Use a towel or some masking tape on the bumper and cover to prevent scratches.



m. Carefully pop off the cover from the bumper.



n. From under the car remove the 2 T25 Torx screws.



o. Remove the plastic clip closest to the wheel.



p. Remove the plastic clip securing the fender liner to the lower front side of the bumper.



q. Pull down the corner of the belly pan to gain access to the inner bumper cavity.

### 3. Installation of AEM® Intake System

a. When installing the intake system, do not completely tighten the hose clamps or mounting hardware until instructed to do so.



b. Install the hump hose with a #40 hose clamp (9440) on the throttle body side and a #44 hose clamp (9444) on the intake tube side.



c. Install the upper intake tube (2-1478) as shown.



d. Align the intake pipe and connect the both PCV hoses as shown.



e. Tighten the #40 hose clamp (9440) on the throttle body side of the hump hose.



f. Tighten the #44 hose clamp (9444) on the hump hose on the intake pipe side.



g. Through the opening exposed from the bumper cover removed in step 2m, loosen the 13mm nut on the chassis.



h. Install the coupler (5-250) onto the middle intake tube (2-1479) and secure with a #40 hose clamp (9440).



i. Guide the middle intake tube down into the engine bay so the end with the coupler is positioned on the lower end.



j. Mount the intake bracket onto the stud where the 13mm nut was loosened in step 3g. Hand tighten the 13mm nut to sandwich the intake tube's bracket between the chassis the 13mm nut.



k. Install the 2.75" to 3.25" coupler (5-328) onto the MAF sensor. Slide a #44 hose clamp (9444) and a #52 hose clamp (9452) onto the coupler as shown.



l. Install the 2.75" to 2.5" coupler (5-257) onto the bottom side of the MAF sensor. Slide a #44 hose clamp (9444) and a #40 hose clamp (9440) onto the coupler as shown.



m. Mount and secure the bracket (32-3084) to the MAF sensor housing using the provided socket head bolts (1-2103) and 4mm washers (08278). Tighten the socket head bolts using a 2.5MM allen wrench.



n. Orient the MAF sensor assembly as shown and attach to the upper and middle intake tubes.



o. Secure the bracket attached to the MAF sensor housing to the vehicle's frame using the provided 10mm bolt (1-2038) and washer (08160).



p. Slide a #40 hose clamp (9440) onto the middle intake tube's lower coupler.



q. Attach the AEM® air filter (21-2011DK) onto the lower intake tube (2-1480) using a #44 hose clamp (9444).





r. Pull the belly pan down to gain access to the inner bumper cavity.



s. Attach the lower intake tube to the middle intake tube coupler. Orient the intake tubes and air filter and ensure the entire assembly has adequate clearance.

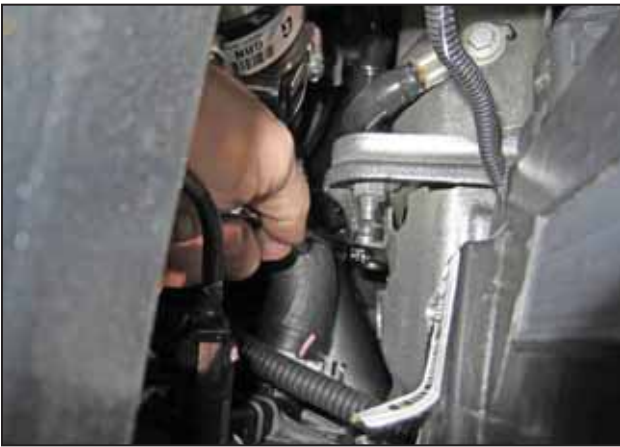

t. Reach down into the engine bay and use a box wrench to tighten the 13mm chassis nut to secure the middle intake tube.



u. Connect the MAF sensor extension harness (21780) to the MAF sensor and engine wiring harness as shown.



v. Secure the MAF sensor extension harness with the two provided zip ties (1-113) to prevent the wiring harness from moving around.



w. Ensure all hose clamps are tightened and secure.



x. Reinstall the front cover and belly pan.



AEM® intake system installed

#### 4. Reassemble Vehicle

- a. Position the inlet pipes for the best fitment. Be sure that the pipes or any other components do not contact any part of the vehicle. Tighten the rubber mount, all bolts, and hose clamps.
- b. Check for proper hood clearance. Re-adjust pipes if necessary and re-tighten them.
- c. Inspect the engine bay for any loose tools and check that all fasteners that were moved or removed are properly tightened.
- d. Reconnect the negative battery terminal and start the engine. Let the vehicle idle for 3 minutes. Perform a final inspection before driving the vehicle.

#### 5. Service and Maintenance

- a. AEM Induction Systems requires cleaning the intake system's air filter element every 100,000 miles. When used in dusty or off-road environments, our filters will require cleaning more often. We recommend that you visually inspect your filter once every 25,000 miles to determine if the screen is still visible. When the screen is no longer visible some place on the filter element, it is time to clean it. To clean, purchase our Synthetic air filter cleaner, part number 99-0624 and follow the easy instructions.
- b. Use aluminum polish to clean your polished AEM® intake tube.
- c. Use window cleaner to clean your powder coated AEM® intake tube. (NOTE: DO NOT USE aluminum polish on powder coated AEM® intake tubes).