



Equipped with AEM® *Dryflow™ Filter*
No Oil Required!

INSTALLATION INSTRUCTIONS

PART NUMBER: 21-697

2009-2010 ACURA TSX L4-2.4L C.A.R.B. E.O. # D-670-6

PARTS LIST

	Description	Qty.	Part Number
A	1/2" Bnd. Hose Clamp, 2.56"-3.50"	2	9448
B	Hose, Adapter 3.25/3.00 X 2.25"	2	5-323
C	1/2" Bnd. Hose Clamp, 2.90"-3.75"	3	9452
D	Hose Clamp, 3/4"	2	4093-5
E	Hose; 5/16ID X 8"L	1	5-2008
F	Hose Clamp #10 Mini	2	08411
G	Hose; 5/8"ID X 6"L	1	5-7006
H	Tube; Upper	1	2-1425
I	Venturi; Plastic	1	9-0378
J	Tube; Lower	1	2-1426
K	Mount, Rubber 1" X 6mm	1	1228599
L	Washer, 6mm Soft Mount	2	08160
M	Nut, M6 Hex Serrated	2	444.460.04
N	Element Parts Kit 3.00 X 5" Dry Ele.	1	21-203DK

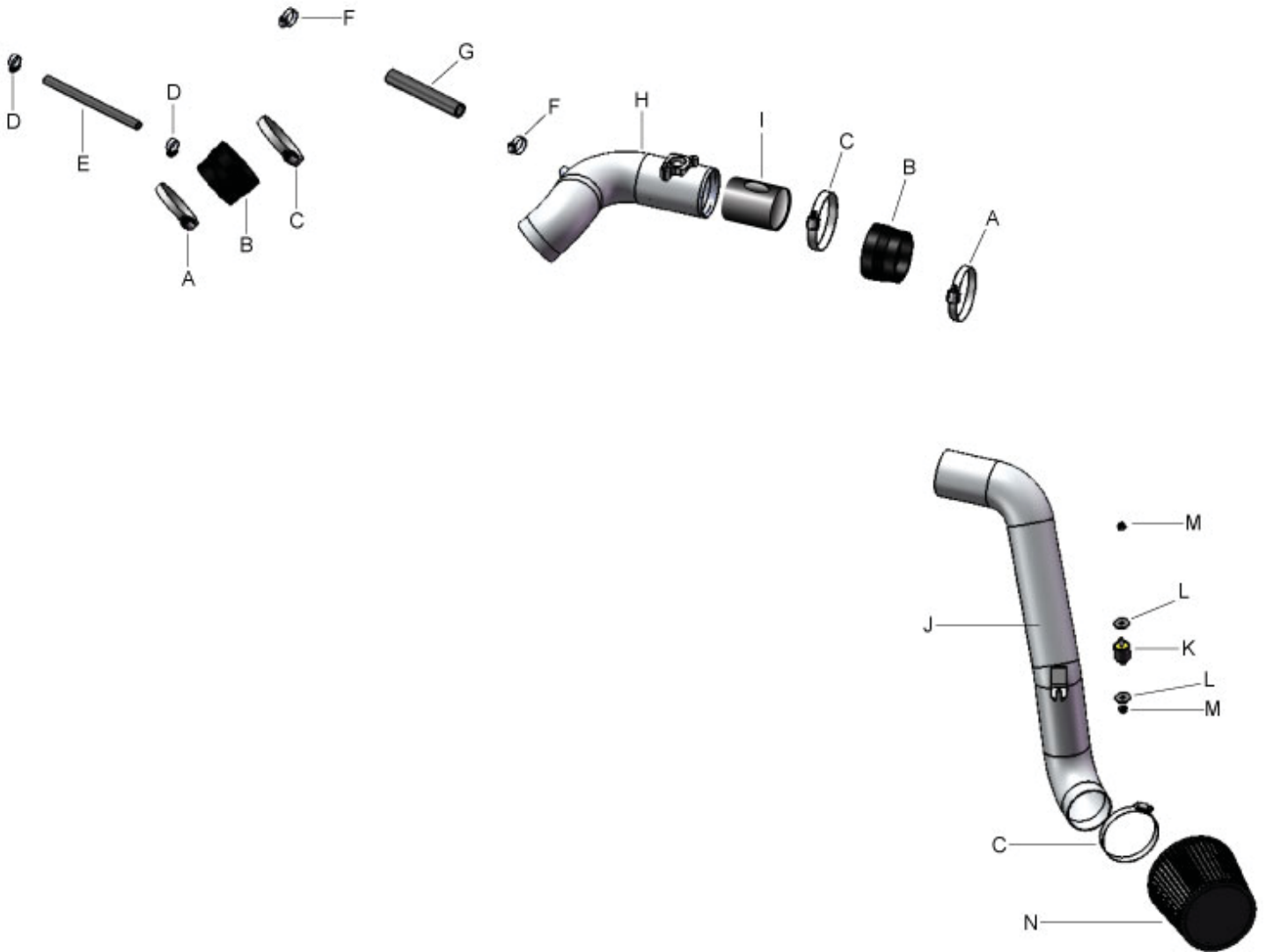

Read and understand these instructions **BEFORE** attempting to install this product. Failure to follow installation instructions and not using the provided hardware may damage the intake tube, throttle body and engine.

The AEM® intake system is a performance product that can be used safely during mild weather conditions. During harsh and inclement weather conditions, you must return your vehicle to stock OEM air box and intake tract configuration. Failure to follow these instructions will void your warranty.

1. Preparing Vehicle

- a. Make sure vehicle is parked on level surface.
- b. Set parking brake.
- c. If engine has run in the past two hours, let it cool down.
- d. Disconnect the negative and positive battery terminals.
- e. Do not discard stock components after removal of the factory system.

2. Removal of stock system



a. Stock air box system.



b. Disconnect & remove battery.



c. Disconnect the power wire clip.



d. Remove two 10mm bolts securing the ECU bracket.



e. Using a flat screwdriver, loosen and remove the two plastic clips securing the resonator bracket. Remove the bracket from the vehicle.



f. Disconnect the MAF sensor wire connector from the MAF sensor.



g. Release the zip tie clip that secures the MAF sensor wire to the air inlet assembly.



h. Remove the MAF sensor wire from the inlet tube.



i. Loosen the 10mm hose clamp on throttle body.



j. Release the spring clamp and remove the PCV hose from the inlet tube.



k. Release the spring clamp and remove the PCV hose from the valve cover.



l. Loosen and remove the 10mm bolt at the top of the air box.



m. Remove the 10mm bolt located at the bottom of the air box.



n. Remove the stock air box.



o. Raise the front of the vehicle with a jack. Refer to your owner's manual for proper jack and jack stand placement to properly support vehicle. Support your vehicle using properly rated jack stands before wheel removal or while working under the vehicle. **NEVER WORK UNDER A VEHICLE WITHOUT USING JACK STANDS.** Remove the driver side front wheel.



p. Remove the clips securing the fender liner and partially remove the fender liner as shown.



q. Locate the resonator from underneath the fender well.



r. Loosen and remove the upper 10mm bolt securing the resonator.



s. Loosen and remove the lower 10mm bolt securing the resonator.



t. The resonator can now be removed from the fender well.



u. Loosen the two 12mm bolts on the bottom of the battery tray.

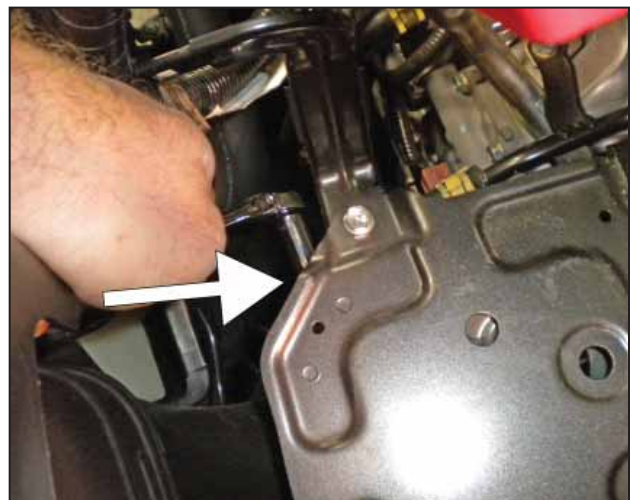

v. Remove the 10mm bolt securing the intake duct.



w. Remove the two 12mm bolts on the top of the battery tray.



x. Remove the battery tray and intake duct.



y. Remove the two phillips screws and remove the mass air sensor from the air box assembly.

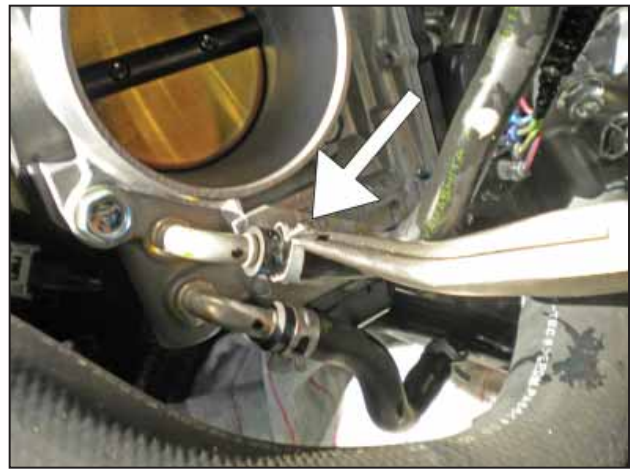

z. **CAUTION: Ensure the engine is completely cool before removing the coolant hose, or hot coolant will escape from the cooling system and cause injury or damage. Be sure to capture any lost coolant in a clean container.** Release the spring clamp on the throttle body coolant line.



aa. Disconnect the hose clamp at the thermostat housing and remove the coolant and PCV hoses.

3. Installation of AEM® intake system.

a. When installing the intake system, do not completely tighten the hose clamps or mounting hardware until instructed to do so.

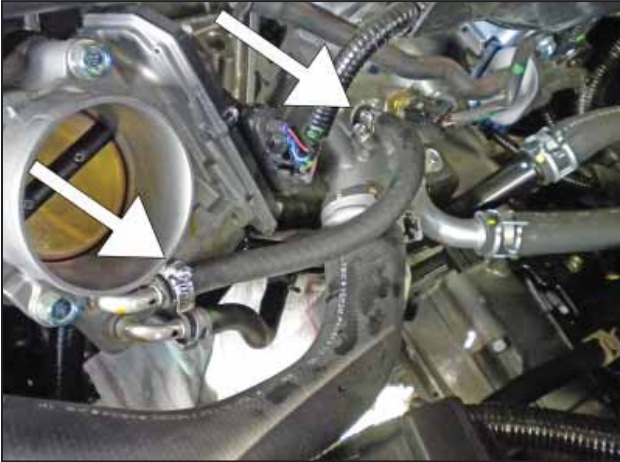

b. Install the supplied 5/16" hose connecting one end to the throttle body hard line and the other to the thermostat housing. Secure the hose with the two supplied small hose clamps.



d. Install the MAF sensor using the stock screws.



f. Install the reducer coupler on the throttle body.



c. Install the venturi in the upper intake tube as shown.



e. Install the supplied 5/8" PCV hose and secure to the intake pipe with the hose clamps as shown.



g. Install the reducer coupler on the MAF side of the intake tube.



h. Attach the intake tube to the reducer coupler and loosely secure with a #52 hose clamp. Connect the PCV hose to the valve cover. Ensure that the installed intake components are not completely tightened until the installation of the intake system is complete.



i. Attach the supplied rubber mount onto the lower intake tube bracket as shown.



j. Install the lower intake tube as shown.



k. Secure the rubber mount previously installed on the intake tube bracket with the provided M6 washer and nut as shown.



l. Install the AEM® Dryflow™ air filter.



m. Ensure there is sufficient clearance around the intake tubes. Once proper fitment is achieved, tighten all hose clamps and hardware.



n. Plug in the MAF sensor wire connector into the MAF sensor.



AEM® intake system installed

4. Reassemble Vehicle

- a. **Fender Liner:** Install the fender liner and any hardware that was removed during steps 2o and 2p.
NOTE: Failure to install the fender liner will result in diminished performance and increase the potential for engine damage due to water ingestion in rainy conditions.
- b. **Wheel:** Install the driver side wheel using the factory torque specification (see owner's manual).
- c. Replace any coolant recovered during the hose removal (**step 2z**) by replenishing the captured coolant into the recovery tank.
- d. Position the inlet pipes for the best fitment. Be sure that the pipes or any other components do not contact any part of the vehicle. Tighten the rubber mount, all bolts, and hose clamps.
- e. Check for proper hood clearance. Re-adjust pipes if necessary and re-tighten them.
- f. Inspect the engine bay for any loose tools and check that all fasteners that were moved or removed are properly tightened.
- g. Reinstall the battery.
- h. Reconnect the positive battery terminal and the negative battery terminal; then start engine. Let the vehicle idle for 3 minutes. Perform a final inspection before driving the vehicle.

5. CARB Sticker Placement

- a. The C.A.R.B. exemption sticker, (attached), must be visible under the hood so that an emissions inspector can see it when the vehicle is required to be tested for emissions. California requires testing every two years, other states may vary.

6. Service and Maintenance

- a. AEM Induction Systems requires cleaning the intake system's air filter element every 100,000 miles. When used in dusty or off-road environments, our filters will require cleaning more often. We recommend that you visually inspect your filter once every 25,000 miles to determine if the screen is still visible. When the screen is no longer visible some place on the filter element, it is time to clean it. To clean, purchase our Synthetic air filter cleaner, part number 99-0624 and follow the easy instructions.
- b. Use window cleaner to clean your powder coated AEM® intake tube.

NOTE: DO NOT USE aluminum polish on powder coated AEM® intake tubes.