



Equipped with AEM® *Dryflow™* Filter  
No Oil Required!

# **INSTALLATION INSTRUCTIONS**

## **PART NUMBER: 21-690**

---

2006-2009 HONDA S2000 L4-2.2L C.A.R.B. E.O. # D-670-6

## PARTS LIST

	Description	Qty.	Part Number
A	Air Filter Assy. 3.25 X 7" Dry Ele.	1	21-2113DK
B	Upper Pipe	1	2-6901
C	Middle Pipe	1	2-6902
D	Lower Pipe	1	2-6903 </td
E	Hose, Silicone 3.25 X 2.0" Blk.	2	5-326
F	Hose, Adapter 3.25/3.00 X 2.25"	1	5-323
G	Adapter, PCV	1	8-168
H	Mount, Rubber 1" X 6mm	1	1228599
I	Stud; Mount Rubber, M6 X 1 M/F	1	02033
J	Grommet, 3/8"	1	784633
K	Zip Tie, 11.25 Long	1	21590
L	Washer, 6mm Soft Mount	3	08160
M	Washer; 1/4"ID X 5/8"OD - SAE	1	08275
N	Nut, M6 Hex Serrated	4	444.460.04
O	Hose Clamp, 3/4"	1	4093-5
P	1/2" Bnd. Hose Clamp, 3.15"-4.00"	1	9456
Q	1/2" Bnd. Hose Clamp, 2.90"-3.75"	5	9452
R	1/2" Bnd. Hose Clamp, 2.31-3.25"	1	9444
S	Screw; Set M6X1X25	1	1-1018

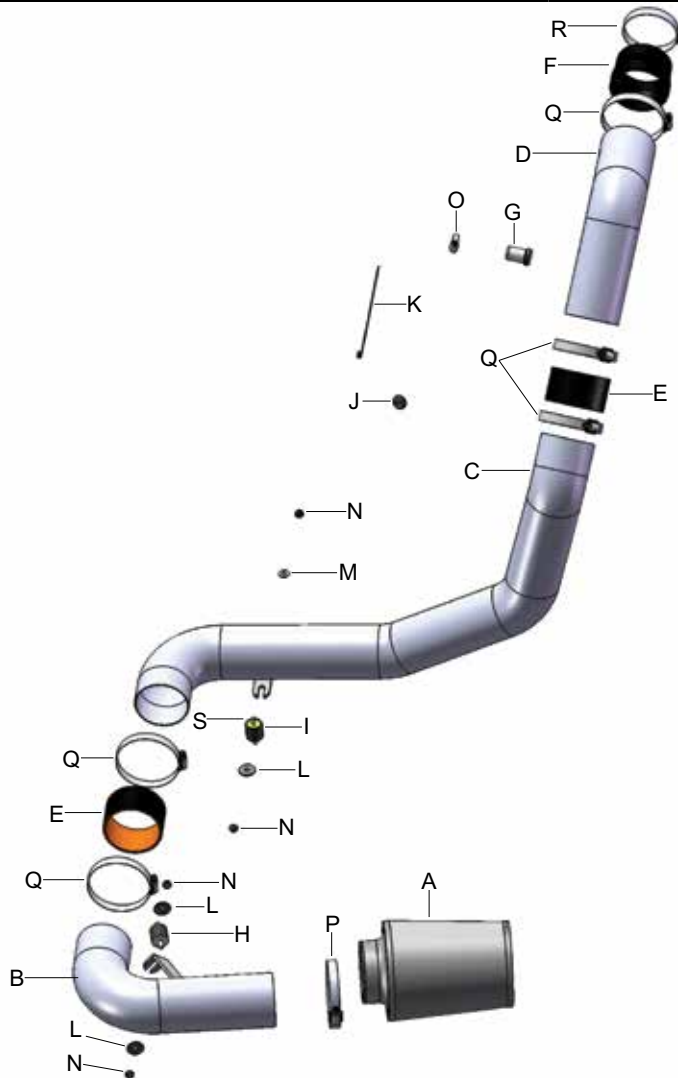

Read and understand these instructions **BEFORE** attempting to install this product. Failure to follow installation instructions and not using the provided hardware may damage the intake tube, throttle body and engine.

The AEM® intake system is a performance product that can be used safely during mild weather conditions. During harsh and inclement weather conditions, you must return your vehicle to stock OEM air box and intake tract configuration. Failure to follow these instructions will void your warranty.

## 1. Preparing Vehicle

- a. Make sure vehicle is parked on level surface.
- b. Set parking brake.
- c. If engine has run in the past two hours, let it cool down.
- d. Disconnect negative battery terminal.
- e. Raise the front of the vehicle with a jack. Refer to your owner's manual for proper jack and jack stand placement to properly support vehicle. Support your vehicle using properly rated jack stands before wheel removal or while working under the vehicle.  
**NEVER WORK UNDER A VEHICLE WITHOUT USING JACK STANDS.**
- f. Do not discard stock components after removal of the factory system.

## 2. Removal of stock system



a. Stock air box system.



b. Remove the wire harness connected to the inlet tube.

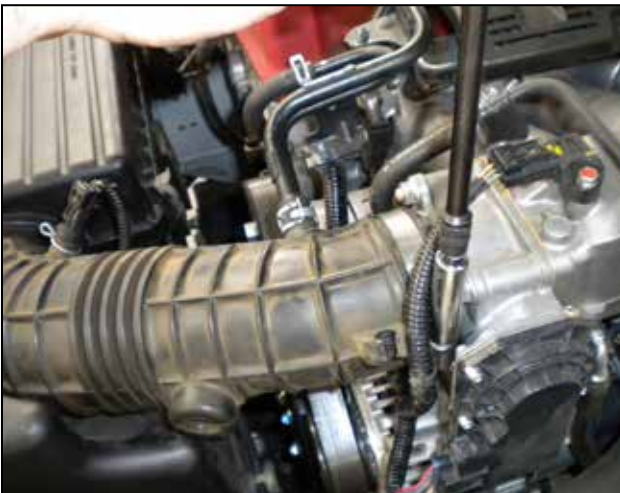

c. Loosen the hose clamp securing the inlet tube to the throttle body.



d. Disconnect the IAT sensor connector from the sensor.





e. Disconnect the wire harness from the inlet tube.



f. Remove the bolt securing the air box on the driver side of the vehicle.



g. Remove the bolt securing the air box on the passenger side of the vehicle.



h. Remove the bolt securing the air box on the firewall side of the air box.



i. Disconnect the PCV hose connected to the valve cover port.



j. Disconnect the PCV hard line from the inlet tube.

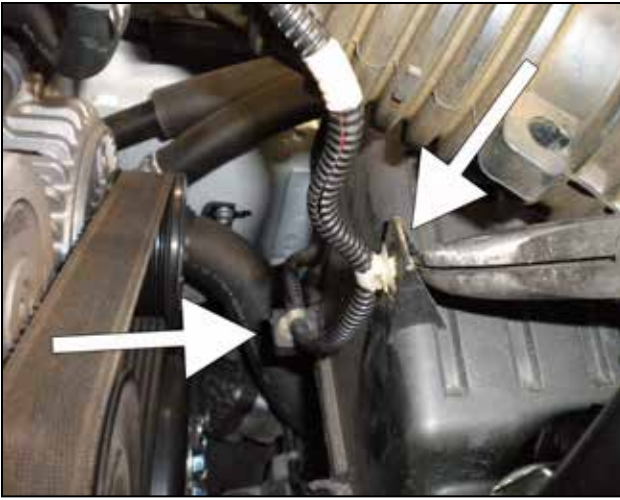

k. Disconnect the zip tie securing the IAT harness to the air box.



l. Disconnect the second zip tie securing the IAT harness to the air box; then remove the air box.



m. Remove the IAT sensor from the inlet tube.



n. Remove passenger side wheel.



o. Remove the passenger fender liner and the bottom front and rear liner.



### 3. Installation of AEM® intake system.

a. When installing the intake system, do not completely tighten the hose clamps or mounting hardware until instructed to do so.



b. Install the PCV adapter in the upper pipe.



c. Install the straight coupler on the upper pipe.



d. Loosely install the hose clamp on the PCV adapter.



e. Install the grommet in the middle pipe.



f. Install the IAT sensor into the middle pipe.



g. Install the reducer coupler with the hose clamps onto the throttle body.



h. Insert the upper pipe in the reducer coupler and install the PCV line into the adapter as shown.



i. Loosely install two hose clamps onto the straight coupler installed on the upper pipe.



j. Install the rubber mount with the female side down, and install the set screw so it is 3/8" from end of rubber. The set screw will go through the vehicle frame; secure with a washer and nut.

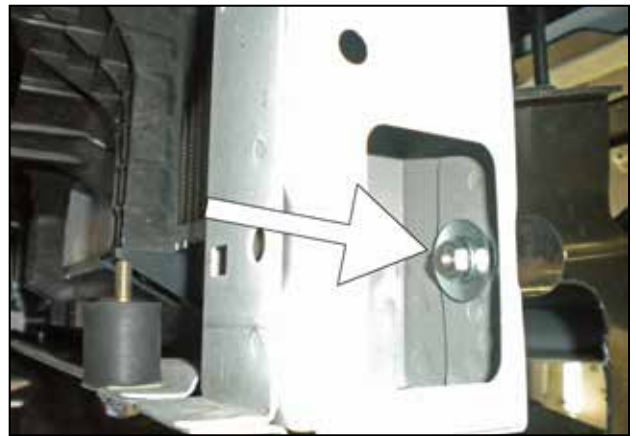

k. Install the second rubber mount as shown. Secure with a washer and nut.



l. Install the middle pipe in the vehicle and align the bracket with the first rubber mount installed.

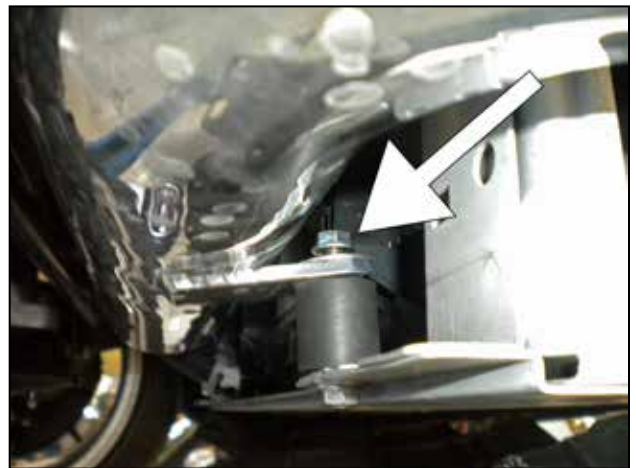

m. Loosely secure the middle intake pipe with the washer and nut as shown.





n. Connect the middle pipe to the upper pipe that is already installed.



o. Install a straight coupler and two hose clamps onto the lower pipe.



p. Install the air filter on the lower pipe.



q. Connect the lower pipe to the middle pipe.



r. Align the lower pipe bracket with the rubber mount as shown.



s. Secure with a washer and nut.





t. Re-install the bottom liners and trim to fit.



u. Reinstall the fender liner and trim to fit.



v. Plug the IAT sensor harness connector back onto the IAT sensor.



w. Zip tie the IAT harness to the large wire harness located on the frame rail.



AEM® intake system installed

#### **4. Reassemble Vehicle**

- a. Position the inlet pipes for the best fitment. Be sure that the pipes or any other components do not contact any part of the vehicle. Tighten the rubber mount, all bolts, and hose clamps.
- b. Check for proper hood clearance. Re-adjust pipes if necessary and re-tighten them.
- c. Inspect the engine bay for any loose tools and check that all fasteners that were moved or removed are properly tightened.
- d. Reconnect negative battery terminal and start engine. Let the vehicle idle for 3 minutes. Perform a final inspection before driving the vehicle.

#### **5. CARB Sticker Placement**

- a. The C.A.R.B. exemption sticker, (attached), must be visible under the hood so that an emissions inspector can see it when the vehicle is required to be tested for emissions. California requires testing every two years, other states may vary.

#### **6. Service and Maintenance**

- a. AEM Induction Systems requires cleaning the intake system's air filter element every 100,000 miles. When used in dusty or off-road environments, our filters will require cleaning more often. We recommend that you visually inspect your filter once every 25,000 miles to determine if the screen is still visible. When the screen is no longer visible some place on the filter element, it is time to clean it. To clean, purchase our Synthetic air filter cleaner, part number 99-0624 and follow the easy instructions.
- b. Use window cleaner to clean your powder coated AEM® intake tube.

**NOTE: DO NOT USE aluminum polish on powder coated AEM® intake tubes.**