



INSTALLATION INSTRUCTIONS

21-873C

HYUNDAI

2019-20 Veloster N

L4-2.0L Turbo

NOT LEGAL FOR SALE OR USE ON ANY POLLUTION CONTROLLED MOTOR VEHICLE IN CALIFORNIA OR STATES ADOPTING CALIFORNIA EMISSION PROCEDURES.

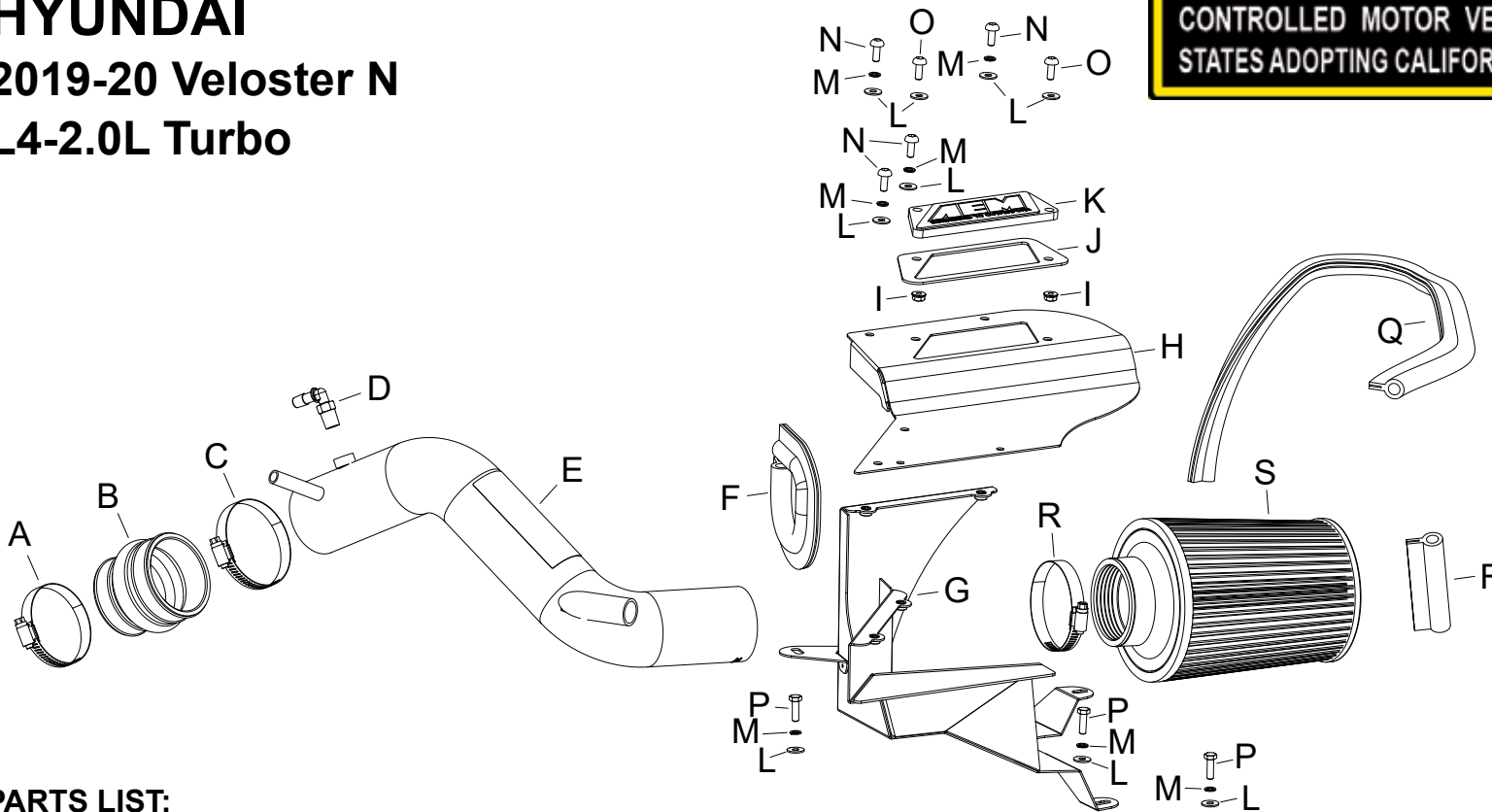

TOOLS NEEDED:

Ratchet
Extension
universal
5/16" socket
10mm socket
4mm allen key
9/16" wrench
Flat blade screw driver

PARTS LIST:

Description	Qty.	Part #	Description	Qty.	Part #	Description	Qty.	Part #
A HOSE CLAMP #40	1	08554	H HEAT SHIELD LID	1	073299	O BOLT; M6 X 1.00 X 16MM, SS	2	07730
B HOSE; HUMP 2.5"/2.75" X 3"	1	5-1067	I NUT; M6, HEX, SERRATED	2	444.460.04	P BOLT; 6MM-1.00 X 16MM, SS	3	07812
C HOSE CLAMP #44 STAINLESS	1	08560	J SPACER; ALUM, AEM-8-211	1	7-364	Q EDGE TRIM (20")	1	102494A
D FITTING; VENT 1/4NPT, 90DEG.	1	08523	K PLATE; AEM LOGO, CLEAR	1	8-211	R 1/2" BNDHOSE CLAMP, 2.56"	1	9448
E INTAKE TUBE	1	25830C	L WASHER; 6MM FLAT, SS	9	08269	S FILTER	1	21-2027DK
F EDGE TRIM (35")	1	102471A	M WASHER, M6 SPLIT LOCK ZINC	7	1-3025			
G HEAT SHIELD	1	073298	N BOLT; M6 X 1.00" 12MM, SS	4	07794			

Read and understand these instructions BEFORE attempting to install this product. Failure to follow installation instructions and not using the provided hardware may damage the intake tube, throttle body and engine.

TO START:

1. Turn off the ignition and disconnect the negative battery cable.
NOTE: Disconnecting the negative battery cable erases pre-programmed electronic memories. Write down all memory settings before disconnecting the negative battery cable. Some radios will require an anti-theft code to be entered after the battery is reconnected. The anti-theft code is typically supplied with your owner's manual. In the event your vehicles anti-theft code cannot be recovered, contact an authorized dealership to obtain your vehicles anti-theft code.



2. Release the spring clamps and then disconnect the vent lines and BOV hose.



3. Loosen the hose clamps that secure the factory intake tube and then remove the intake tube from the vehicle.



4. Remove the two push pins that secure the fresh air intake duct. Remove the three bolts that secure the factory air filter housing and then remove the housing from the vehicle.

NOTE: AEM recommends that customers do not discard factory air intake.



5. Cut the provided edge trim into sections of 6", 10-1/2", 14" from the 35" and then install it onto the heat shield as shown.



6. Install the heat shield into the vehicle and secure with the provided hardware.



7. Install the provided coupler (5-1067) onto the turbo inlet and secure with the provided hose clamp.



8. Install the 90° vent fitting onto the AEM® intake tube as shown.

NOTE: Plastic NPT fittings are easy to cross thread. Install the vent fitting “hand” tight, then turn it two complete turns with a wrench.



9. Install the intake tube into the coupler at the turbo and secure with the provided hose clamp.



10. Install the vent lines and BOV hose onto the AEM® intake tube and secure with the factory spring clamps.



11. Cut the remaining edge trim into lengths of 3" and 14-1/2" and then install onto the heat shield lid as shown.



12. Install the AEM® window into the heat shield lid with the spacer between the lid and window and secure with the provided hardware.



13. Install the AEM® air filter onto the intake tube and secure with the provided hose clamp.



14. Install the heat shield lid and secure with the provided hardware.



Reassemble Vehicle

Position the inlet pipes for the best fitment. Be sure that the pipes or any other components do not contact any part of the vehicle. Tighten the rubber mount, all bolts, and hose clamps. Check for proper hood clearance. Re-adjust pipes if necessary and re-tighten them. Inspect the engine bay for any loose tools and check that all fasteners that were moved or removed are properly tightened. Reconnect negative battery terminal and start engine. Let the vehicle idle for 3 minutes. Perform a final inspection before driving the vehicle.

Service and Maintenance

AEM Induction Systems requires cleaning the intake system's air filter element every 100,000 miles. When used in dusty or off-road environments, our filters will require cleaning more often. We recommend that you visually inspect your filter once every 25,000 miles to determine if the screen is still visible. When the screen is no longer visible some place on the filter element, it is time to clean it. To clean, purchase our Synthetic air filter cleaner, part number 99-0624 and follow the easy instructions. Use window cleaner to clean your powder coated AEM® intake tube.

NOTE: DO NOT USE aluminum polish on powder coated AEM® intake tubes.

NOT LEGAL FOR SALE OR USE ON ANY POLLUTION CONTROLLED MOTOR VEHICLE IN CALIFORNIA OR STATES ADOPTING CALIFORNIA EMISSION PROCEDURES.