



INSTALLATION INSTRUCTIONS

21-872C
HYUNDAI
2019-20 Veloster R
L4-1.6L Turbo

NOT LEGAL FOR SALE OR USE ON ANY POLLUTION CONTROLLED MOTOR VEHICLE IN CALIFORNIA OR STATES ADOPTING CALIFORNIA EMISSION PROCEDURES.

TOOLS NEEDED:

flat blade screw driver
 ratchet
 extension
 10mm socket
 10mm wrench
 4mm allen
 cutters
 pliers

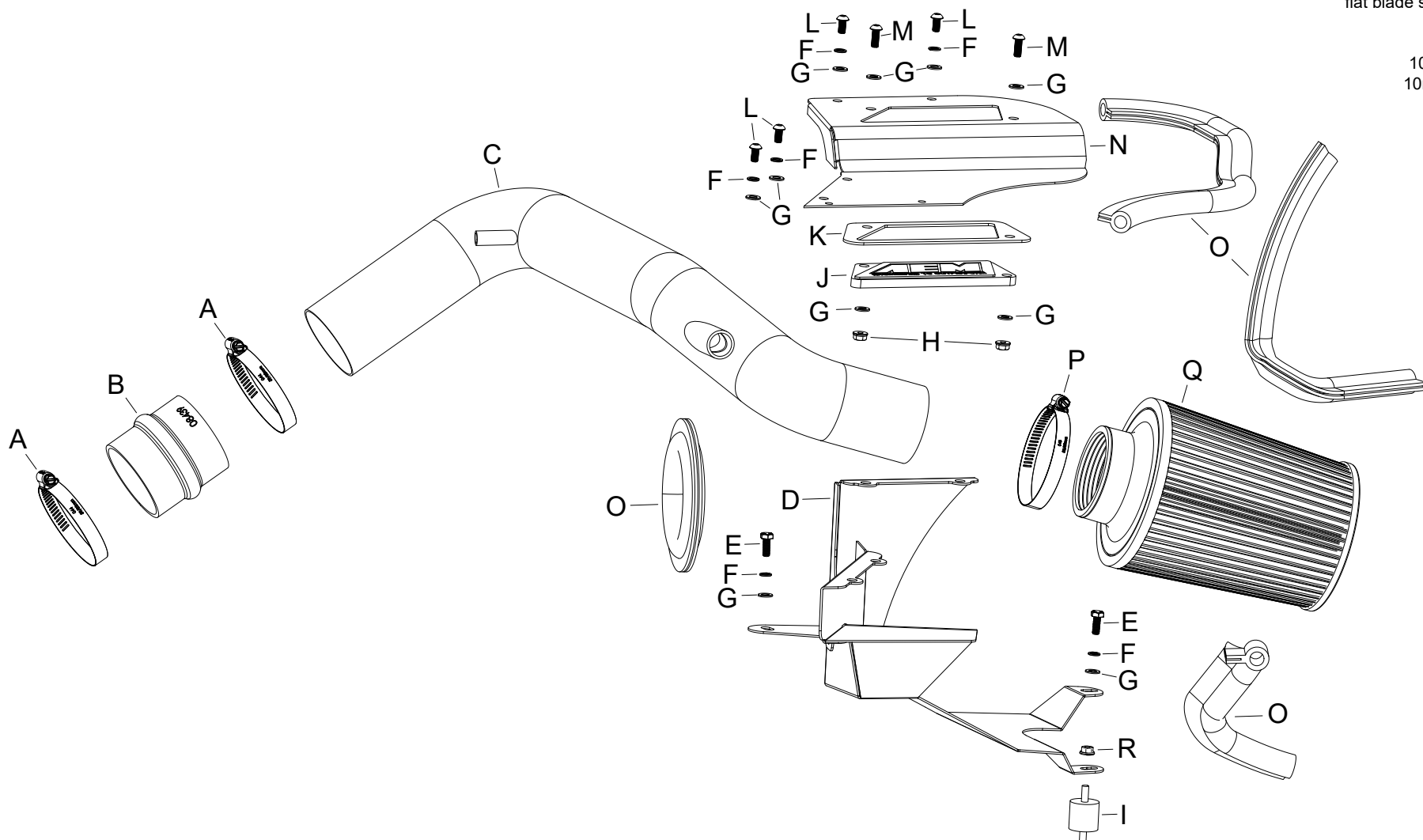

PARTS LIST:

Description	Qty.	Part #	Description	Qty.	Part #	Description	Qty.	Part #
A HOSE CLAMP; #44	2	08577	G WASHER; 6MM FLAT, SS	10	08269	M SCREW; M6 X 20MM, BUTTON	2	KIT20BHC3060
B HOSE; HUMP 2.75"ID X 3"L	1	08439	H NUT; 6MM NYLOCK, HEXHEAD	2	07512	N LID; MILD STL., TB/PC	1	073291
C TUBE; 3"OD X 28"L, AL	1	25827C	I MOUNT, RUBBER 1" X 6MM	1	1228599	O EDGE TRIM; 3/4" BULB, TOP	1	102480A
D HEAT SHIELD; MILD STL.	1	073290	J PLATE; AEM LOGO, CLEAR	1	8-211	P 1/2" BNDHOSE CLAMP, 2.56"	1	9448
E BOLT; M6 X 1.00 X 16MM, SS	2	07812	K SPACER; ALUM, CLEAR BADGE	1	7-364	Q AIR FILTER; 2.75" X 7"	1	21-2027DK
F WASHER; M6 SPLIT LOCK ZINC	6	1-3025	L BOLT; M6 X 1.00" 12MM, SS	4	07794	R NUT; M6, HEX, SERRATED	1	444.460.04

Read and understand these instructions BEFORE attempting to install this product. Failure to follow installation instructions and not using the provided hardware may damage the intake tube, throttle body and engine.

TO START:

1. Turn off the ignition and disconnect the negative battery cable.
NOTE: Disconnecting the negative battery cable erases pre-programmed electronic memories. Write down all memory settings before disconnecting the negative battery cable. Some radios will require an anti-theft code to be entered after the battery is reconnected. The anti-theft code is typically supplied with your owner's manual. In the event your vehicles anti-theft code cannot be recovered, contact an authorized dealership to obtain your vehicles anti-theft code.



2. Lift off the decorative engine cover and set aside.



3. Loosen the clamp that secures the factory intake tube to the turbo inlet pipe. Release the spring clamp that secures the PCV hose to the intake tube and then disconnect the PCV hose.



4. Release the spring clamp that secures the BOV hose to the intake tube and then disconnect the BOV hose.



5. Release the two spring clamps that secure the upper air filter housing and then remove the upper housing and intake hose from the vehicle.



6. Push in the center of the fresh air intake duct retaining pins and then remove the pins from the vehicle.



7. Remove the three bolts that secure the lower air filter housing and then remove the lower housing and fresh air duct from the vehicle.

NOTE: AEM recommends that customers do not discard factory air intake.



8. Cut the provided edge trim into sections as shown.

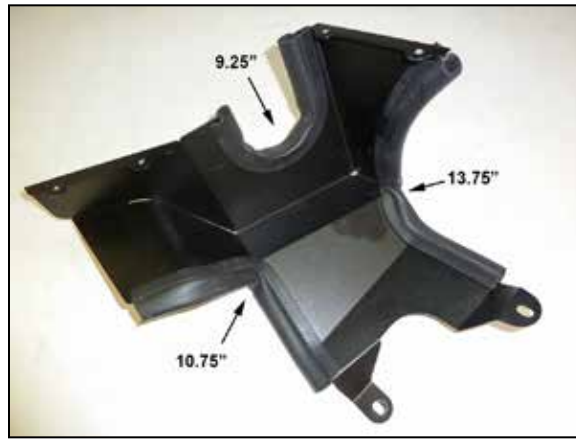

9. Install three of the edge trims onto the heat shield as shown.



10. Install the provided rubber mounted stud into the air filter housing mounting location on the frame rail as shown.



11. Install the heat shield into the vehicle and secure with the hardware provided.



12. Install the provided coupler (08439) onto the turbo inlet and secure with the provided hose clamp.



13. Install the intake tube into the coupler and onto the heat shield, adjust for best fit and then secure with the provided hardware.



14. Connect the PCV hose and BOV hose to the AEM® intake tube and secure with the factory spring clamps.



15. Install the AEM® air filter onto the intake tube and secure with the provided hose clamp.



16. Install the AEM® window into the heat shield lid and secure with the provided hardware. Install the long edge trim onto the heat shield lid.



17. Install the short edge trim onto the lid as shown.



18. Install the heat shield lid and secure with the provided hardware.



19. Reinstall the engine cover.



Reassemble Vehicle

Position the inlet pipes for the best fitment. Be sure that the pipes or any other components do not contact any part of the vehicle. Tighten the rubber mount, all bolts, and hose clamps. Check for proper hood clearance. Re-adjust pipes if necessary and re-tighten them. Inspect the engine bay for any loose tools and check that all fasteners that were moved or removed are properly tightened. Reconnect negative battery terminal and start engine. Let the vehicle idle for 3 minutes. Perform a final inspection before driving the vehicle.

Service and Maintenance

AEM Induction Systems requires cleaning the intake system's air filter element every 100,000 miles. When used in dusty or off-road environments, our filters will require cleaning more often. We recommend that you visually inspect your filter once every 25,000 miles to determine if the screen is still visible. When the screen is no longer visible some place on the filter element, it is time to clean it. To clean, purchase our Synthetic air filter cleaner, part number 99-0624 and follow the easy instructions. Use window cleaner to clean your powder coated AEM® intake tube.

NOTE: DO NOT USE aluminum polish on powder coated AEM® intake tubes.

NOT LEGAL FOR SALE OR USE ON ANY POLLUTION CONTROLLED MOTOR VEHICLE IN CALIFORNIA OR STATES ADOPTING CALIFORNIA EMISSION PROCEDURES.