

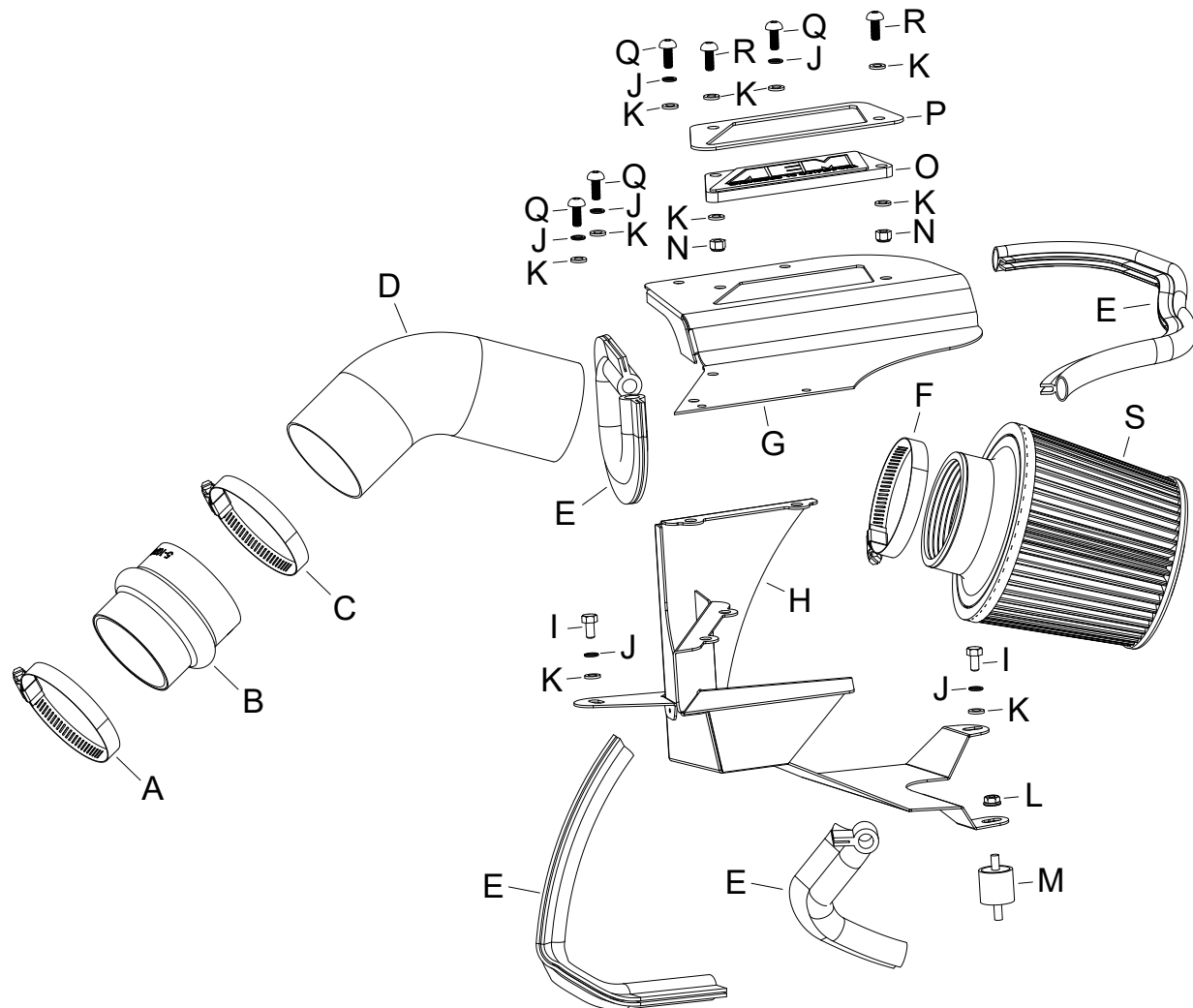

## INSTALLATION INSTRUCTIONS

**21-869C**  
**HYUNDAI**  
**2018-19 Elantra**  
**L4-2.0L**

**NOT LEGAL FOR SALE OR USE ON ANY POLLUTION CONTROLLED MOTOR VEHICLE IN CALIFORNIA OR STATES ADOPTING CALIFORNIA EMISSION PROCEDURES.**



### TOOLS NEEDED:

Flat blade screw driver  
 Phillips screw driver  
 Pliers  
 Cutters  
 10mm socket  
 Ratchet  
 Extension  
 4mm allen key

### PARTS LIST:

Description	Qty.	Part #
A HOSE CLAMP; #44	1	08577
B HOSE; HUMP 3" TO 2.75" X 3"L	1	08421
C HOSE CLAMP; #48	1	08601
D TUBE; 3.0"OD X 9"L, AL	1	25824C
E EDGE TRIM; 3/4" BULB, TOP	1	102480A
F 1/2" BNDHOSE CLAMP, 2.90"	1	9452
G LID; AEM-21-869, MILD STL.	1	073291
H HEAT SHIELD; MILD STL.	1	073290
I BOLT; M6 X 1.00 X 12MM, SS	2	07727
J WASHER; M6 SPLIT LOCK ZINC	6	1-3025
K WASHER; 6MM FLAT, SS	10	08269
L NUT; M6, HEX, SERRATED	1	444.460.04
M MOUNT, RUBBER 1" X 6MM	1	1228599
N NUT; 6MM NYLOCK, HEXHEAD	2	07512
O PLATE; AEM LOGO, CLEAR	1	8-211
P SPACER; ALUM, CLEAR BADGE	1	7-364
Q BOLT; M6 X 1.00" 12MM, SS	4	07794
R SCREW; M6 X 20MM, BUTTON	2	KIT20BHC3060
S AIR FILTER; 3" X 5" DRYFLOW	1	21-203DK

Read and understand these instructions **BEFORE** attempting to install this product. Failure to follow installation instructions and not using the provided hardware may damage the intake tube, throttle body and engine.

### TO START:

1. Turn off the ignition and disconnect the negative battery cable.

**NOTE: Disconnecting the negative battery cable erases pre-programmed electronic memories. Write down all memory settings before disconnecting the negative battery cable. Some radios will require an anti-theft code to be entered after the battery is reconnected. The anti-theft code is typically supplied with your owner's manual. In the event your vehicles anti-theft code cannot be recovered, contact an authorized dealership to obtain your vehicles anti-theft code.**



2. Remove the two push pins that secure the fresh air intake duct and then remove the fresh air intake duct from the vehicle.



3. Loosen the clamp that secures the factory intake hose to the throttle body. Release the spring clamp that secures the crank case vent line and disconnect the crank case vent from the factory intake hose.



4. Release the two upper air filter housing spring clips and then remove the upper housing, intake hose and filter from the vehicle.



5. Remove the three bolts that secure lower air filter housing and then remove the lower air filter housing from the vehicle.

**NOTE: AEM recommends that customers do not discard factory air intake.**



6. Install the provided rubber mounted stud onto the frame rail as shown.



7. Install the provided coupler (#08421) onto the throttle body and secure with the provided hose clamp.



8. Cut the provided edge trim into five sections as shown.



9. Install the three sections of edge trim onto the heat shield as shown.



10. Install the heat shield assembly into the vehicle and secure with the provided hardware.



11. Install the AEM® intake tube into the coupler and connect the crank case vent hose and secure with the factory clamp.



12. Install the AEM® air filter and secure with the provided hose clamp.



13. Install the AEM® logo into the heat shield and secure with the provided hardware. Install the edge trim onto the heat shield as shown.



14. Install the remaining edge trim onto the heat shield as shown.



15. Install the lid onto the heat shield and secure with the provided hardware.



### Reassemble Vehicle

Position the inlet pipes for the best fitment. Be sure that the pipes or any other components do not contact any part of the vehicle. Tighten the rubber mount, all bolts, and hose clamps. Check for proper hood clearance. Re-adjust pipes if necessary and re-tighten them. Inspect the engine bay for any loose tools and check that all fasteners that were moved or removed are properly tightened. Reconnect negative battery terminal and start engine. Let the vehicle idle for 3 minutes. Perform a final inspection before driving the vehicle.

### Service and Maintenance

AEM Induction Systems requires cleaning the intake system's air filter element every 100,000 miles. When used in dusty or off-road environments, our filters will require cleaning more often. We recommend that you visually inspect your filter once every 25,000 miles to determine if the screen is still visible. When the screen is no longer visible some place on the filter element, it is time to clean it. To clean, purchase our Synthetic air filter cleaner, part number 99-0624 and follow the easy instructions. Use window cleaner to clean your powder coated AEM® intake tube.

**NOTE: DO NOT USE aluminum polish on powder coated AEM® intake tubes.**

**NOT LEGAL FOR SALE OR USE ON ANY POLLUTION CONTROLLED MOTOR VEHICLE IN CALIFORNIA OR STATES ADOPTING CALIFORNIA EMISSION PROCEDURES.**