



## INSTALLATION INSTRUCTIONS

**21-868C**  
**ACURA**  
**2009-14 TL**  
**V6-3.5L**

**NOT LEGAL FOR SALE OR USE ON ANY POLLUTION CONTROLLED MOTOR VEHICLE IN CALIFORNIA OR STATES ADOPTING CALIFORNIA EMISSION PROCEDURES.**

### TOOLS NEEDED:

Flat blade screw driver  
 Phillips Screw Driver  
 3mm allen  
 Ratchet  
 Extension  
 10mm socket  
 10mm wrench

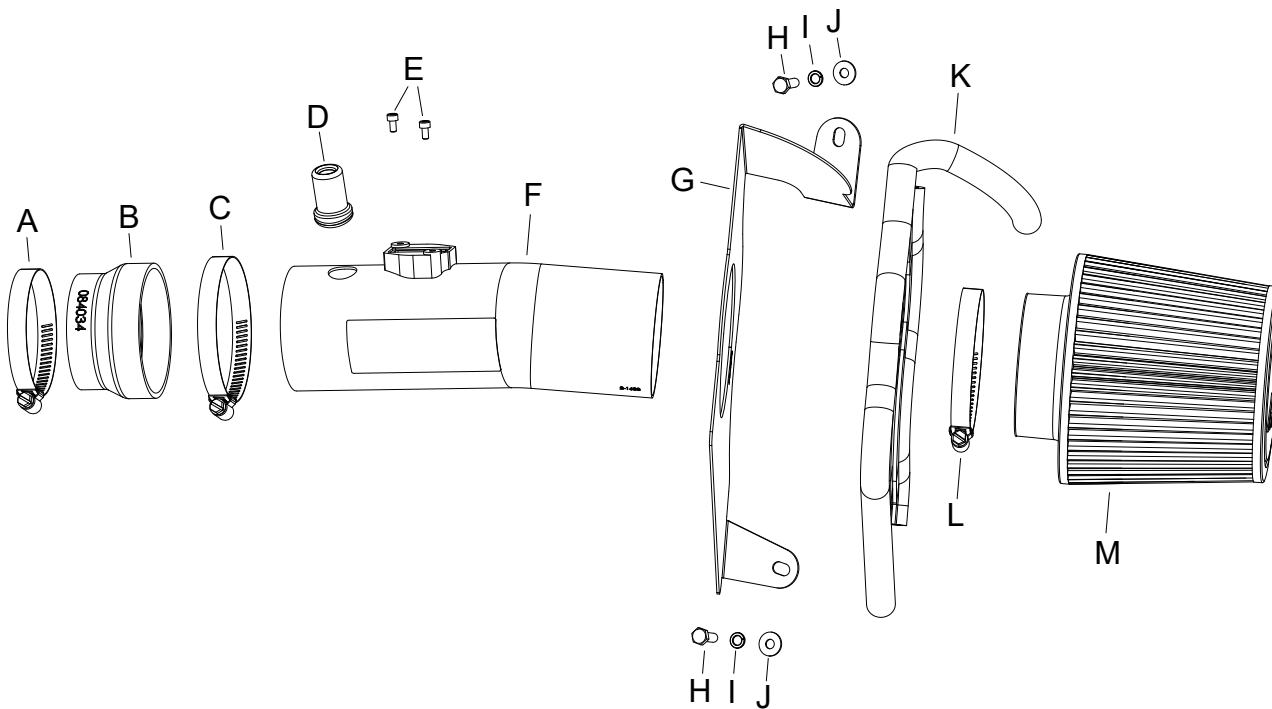

### PARTS LIST:

Description	Qty.	Part #
A HOSE CLAMP; #44	1	08577
B HOSE; 3.25" TO 2.75"ID X 2"L	1	084034
C HOSE CLAMP; #52	1	08610
D ADAPTER; PCV	1	8-168
E BOLT; M4-.7 X 8MM, ALLEN	2	07733
F TUBE; 3.25"OD X 9.5", GRAY	1	2-1638C
G HEAT SHIELD, 2009-14 ACURA	1	20-8656
H BOLT; M6-1.00 X 16MM, SS	2	07812
I WASHER; M6 SPLIT LOCK ZINC	2	1-3025
J WASHER; 6MM FLAT, SS	2	08269
K EDGE TRIM; 3/4" BULB, 46"L	1	102487
L 1/2" BNDHOSE CLAMP, 3.15"	1	9456
M AIR FILTER; 3.25" X 5"	1	21-2110DK

**Read and understand these instructions BEFORE attempting to install this product. Failure to follow installation instructions and not using the provided hardware may damage the intake tube, throttle body and engine.**

### TO START:

1. Turn off the ignition and disconnect the negative battery cable.  
**NOTE: Disconnecting the negative battery cable erases pre-programmed electronic memories. Write down all memory settings before disconnecting the negative battery cable. Some radios will require an anti-theft code to be entered after the battery is reconnected. The anti-theft code is typically supplied with your owner's manual. In the event your vehicles anti-theft code cannot be recovered, contact an authorized dealership to obtain your vehicles anti-theft code.**



2. Remove the pins that secure the drivers side rear decorative engine cover and then remove the cover.



3. Remove the clips that secure the drivers side front decorative cover and then remove the cover.



4. Disconnect the mass air sensor electrical connection.



5. Disconnect the crank case vent tube from the factory intake boot.



6. Loosen the hose clamp that secures the factory intake boot to the throttle body.



7. Loosen the four bolts that secure the upper air filter housing and then remove the upper housing and intake boot.

**NOTE: AEM recommends that customers do not discard factory air intake.**



8. Unclip the wiring harness from the lower air filter housing.



9. Loosen the bolts that secure the lower air filter housing and then remove the lower housing from the vehicle.

**NOTE: It may be necessary to loosen the battery hold down and slide the battery back to access the air box mounting bolt.**



10. Remove the mass air sensor from factory air filter housing and then install into the AEM® intake tube and secure with the provided hardware. Install the crank case vent adapter grommet into the AEM® intake tube as shown.



11. Cut the provided edge trim into sections of 22", 13" and 10.5".



12. Install the edge trim onto the heat shield as shown.



13. Remove the wiring harness mounting bolt shown on the shock tower.



14. Install the heat assembly and secure with the provided hardware.

**NOTE: It may be necessary to move the wiring harness to access the bolt to secure the heat shield.**



15. Install the provided coupler (084034) onto the throttle body and secure with the provided hose clamps.



16. Install the AEM® intake tube into the heat shield and then into the coupler, adjust the tube for best fit and secure with the provided hardware.



17. Reconnect the mass air sensor electrical connection.



18. Install the AEM® air filter onto the intake tube and secure with the provided hose clamp.



19. Reinstall the decorative engine covers and reconnect the negative battery cable.

### Reassemble Vehicle

Position the inlet pipes for the best fitment. Be sure that the pipes or any other components do not contact any part of the vehicle. Tighten the rubber mount, all bolts, and hose clamps. Check for proper hood clearance. Re-adjust pipes if necessary and re-tighten them. Inspect the engine bay for any loose tools and check that all fasteners that were moved or removed are properly tightened. Reconnect negative battery terminal and start engine. Let the vehicle idle for 3 minutes. Perform a final inspection before driving the vehicle.

### Service and Maintenance

AEM Induction Systems requires cleaning the intake system's air filter element every 100,000 miles. When used in dusty or off-road environments, our filters will require cleaning more often. We recommend that you visually inspect your filter once every 25,000 miles to determine if the screen is still visible. When the screen is no longer visible some place on the filter element, it is time to clean it. To clean, purchase our Synthetic air filter cleaner, part number 99-0624 and follow the easy instructions. Use window cleaner to clean your powder coated AEM® intake tube.

**NOTE: DO NOT USE aluminum polish on powder coated AEM® intake tubes.**

**NOT LEGAL FOR SALE OR USE ON ANY POLLUTION CONTROLLED MOTOR VEHICLE IN CALIFORNIA OR STATES ADOPTING CALIFORNIA EMISSION PROCEDURES.**

### AEM Air Intake System Warranty Policy

AEM® warrants that its intake systems will last for the life of your vehicle. AEM will not honor this warranty due to mechanical damage (i.e. improper installation or fitment), damage from misuse, accidents or flying debris. AEM will not warrant its powder coating if the finish has been cleaned with a hydrocarbon-based solvent. The powder coating should only be cleaned with a mild soap and water solution. Proof of purchase of both the vehicle and AEM intake system is required for redemption of a warranty claim.

This warranty is limited to the repair or replacement of the AEM part. In no event shall this warranty exceed the original purchase price of the AEM part nor shall AEM be responsible for special, incidental or consequential damages or cost incurred due to the failure of this product. Warranty claims to AEM must be transportation prepaid and accompanied with dated proof of purchase. This warranty applies only to the original purchaser of product and is nontransferable. Improper use or installation, use for racing, accident, abuse, unauthorized repairs or alterations voids this warranty. AEM disclaims any liability for consequential damages due to breach of any written or implied warranty on all products manufactured by AEM. Warranty returns will only be accepted by AEM when accompanied by a valid Return Merchandise Authorization (RMA) number. Credit for defective products will be issued pending inspection. Product must be received by AEM within 30 days of the date RMA is issued.