



INSTALLATION INSTRUCTIONS

21-848C (Gun Metal Gray Finish)

HYUNDAI / KIA

2015-18 Sonata / Optima

L4-2.4L

TOOLS NEEDED:

ratchet
Extension
10mm socket
10mm wrench
flat blade screw driver
4mm allen

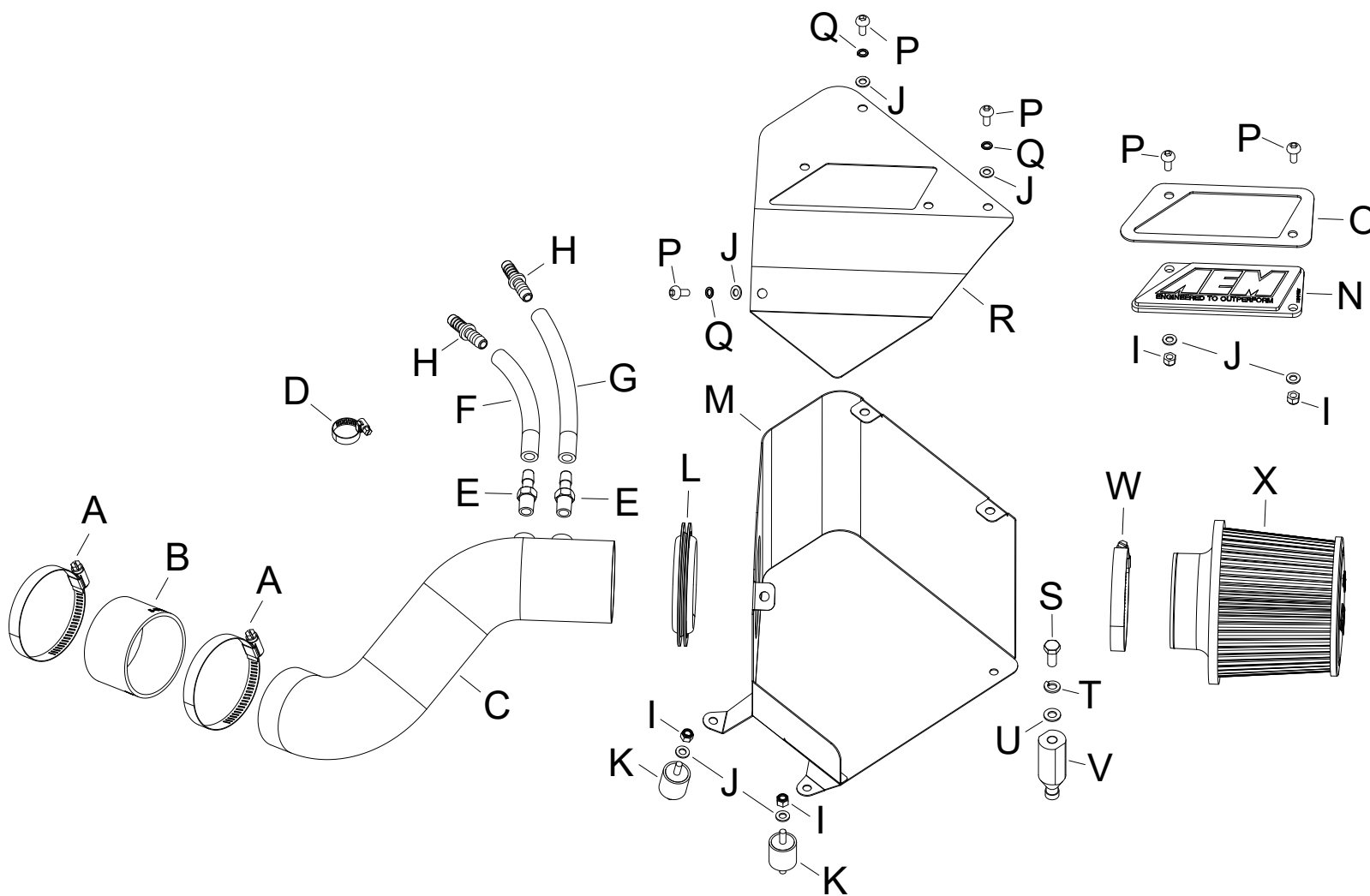

PARTS LIST:

Description	Qty.	Part #	Description	Qty.	Part #	Description	Qty.	Part #
A HOSE CLAMP #48	2	08601	I NUT; 6MM NYLOCK, HEXHEAD	4	07512	Q WASHER, M6 SPLIT LOCK ZINC	3	1-3025
B HOSE; 3" ID X 2"L REIN	1	08711	J WASHER; 6MM FLAT, SS	7	08269	R HEAT SHIELD, LID, 201-2015	1	20-8632
C TUBE; 3"OD X 16"L, 21-848	1	2-1620C	K MOUNT; RUBBER 1" X 6MM	2	1228599	S BOLT; 8MM-1.25 X 20MM HEX	1	07787
D HOSE CLAMP #004	1	21850	L EDGE TRIM; 3/4"BULB; TOP	1	102474	T WASHER, M8 SPLIT LOCK ZINC	1	1-3036
E FITTING; VENT, STRT, 3/8" NPT	2	08047	M HEAT SHIELD, 201-2015	1	20-8631	U WASHER; 8MM, FLAT, SS	1	08272
F HOSE; 3/8"ID X 5"L	1	08717	N PLATE; AEM LOGO, CLEAR	1	8-211	V STANDOFF; 6.0 FORD AIRBOX	1	06532
G HOSE; 3/8"ID X 7"L	1	5-1007	O SPACER; ALUM, AEM-8-211	1	7-364	W 1/2" BNDHOSE CLAMP, 2.90"	1	9452
H VENT; STRT, 3/8"HOSE	2	08041	P BOLT; M6 X 1.00 X 16MM	5	07730	X 6"FLG, 7-1/2"B, 4-1/2"T, 4"H	1	21-203DK

Read and understand these instructions BEFORE attempting to install this product. Failure to follow installation instructions and not using the provided hardware may damage the intake tube, throttle body and engine.

TO START:

1. Turn off the ignition and disconnect the negative battery cable.
NOTE: Disconnecting the negative battery cable erases pre-programmed electronic memories. Write down all memory settings before disconnecting the negative battery cable. Some radios will require an anti-theft code to be entered after the battery is reconnected. The anti-theft code is typically supplied with your owner's manual. In the event your vehicles anti-theft code cannot be recovered, contact an authorized dealership to obtain your vehicles anti-theft code.



2. Lift off the decorative engine cover. Remove the fresh air intake duct from the factory air filter housing and core support.



3. Disconnect the breather hoses from the factory intake tube and intake plenum.



4. Loosen the hose clamps that secure the factory intake tube and then remove the intake tube from the vehicle.



5. Remove the two bolts that secure the factory air filter housing and then remove the factory housing from the vehicle.

NOTE: AEM recommends that customers do not discard factory air intake.



6. Install the provided coupler hose (08711) onto the throttle body and secure with the provided hose clamp.



7. Install the two provided rubber mounted studs into the factory air filter housing mounting locations.

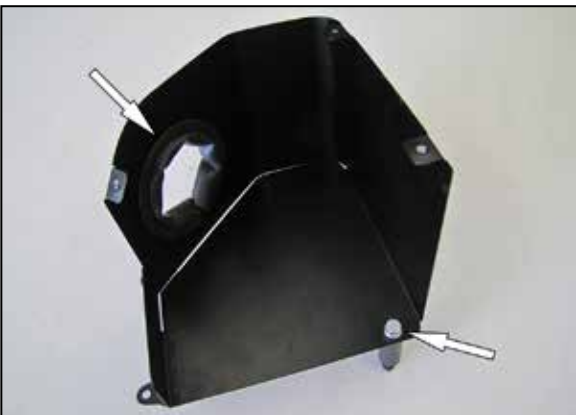

8. Install the provided mounting stud onto the heat shield as shown. Install the provided edge trim into the hole of the heat shield as shown.

NOTE: Some trimming of the edge trim will be necessary.



9. Install the heat shield into the vehicle so the mounting stud inserts into the mounting grommet and it aligns with the rubber mounted studs, then secure with the provided hardware.



10. Install the provided vent lines and fittings onto the AEM intake tube as shown.

NOTE: Plastic NPT fittings are easy to cross thread. Install the vent fitting "hand" tight, then turn it two complete turns with a wrench.



11. Install the AEM intake tube into the heat shield and into the coupler at the throttle body, adjust the tube for best fit and then secure with the provided hose clamp.



12. Install the AEM air filter onto the intake tube and secure with the provided hose clamp.

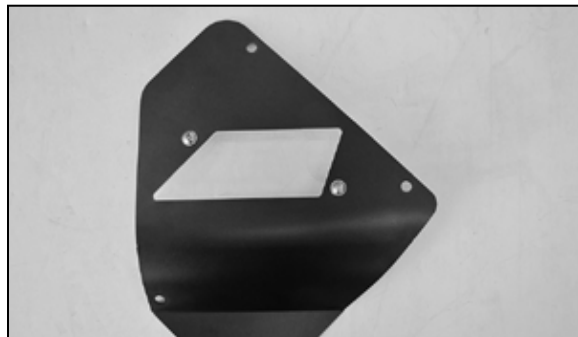

13. Install the AEM badge into the heat shield cover and secure with the provided hardware.



14. Install the cover onto the heat shield and secure with the provided hardware.



15. Connect the factory vent lines to the lines installed onto the AEM intake tube.



Reassemble Vehicle

Position the inlet pipes for the best fitment. Be sure that the pipes or any other components do not contact any part of the vehicle. Tighten the rubber mount, all bolts, and hose clamps. Check for proper hood clearance. Re-adjust pipes if necessary and re-tighten them. Inspect the engine bay for any loose tools and check that all fasteners that were moved or removed are properly tightened. Reconnect negative battery terminal and start engine. Let the vehicle idle for 3 minutes. Perform a final inspection before driving the vehicle.

Service and Maintenance

AEM Induction Systems requires cleaning the intake system's air filter element every 100,000 miles. When used in dusty or off-road environments, our filters will require cleaning more often. We recommend that you visually inspect your filter once every 25,000 miles to determine if the screen is still visible. When the screen is no longer visible some place on the filter element, it is time to clean it. To clean, purchase our Synthetic air filter cleaner, part number 99-0624 and follow the easy instructions. Use window cleaner to clean your powder coated AEM intake tube.

NOTE: DO NOT USE aluminum polish on powder coated AEM intake tubes.