

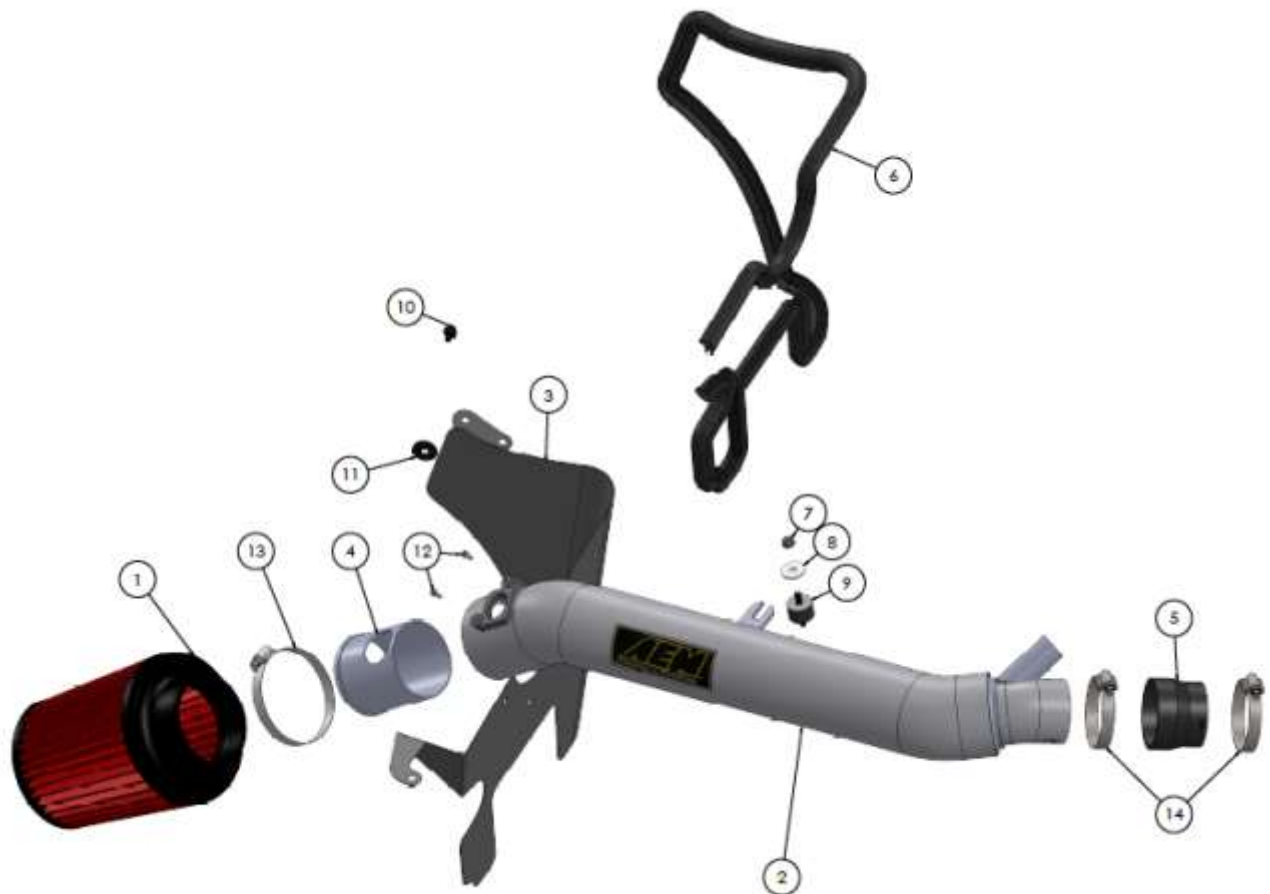

Equipped with AEM® Dryflow™ Filter
No Oil Required!

INSTALLATION INSTRUCTIONS
PART NUMBER
21-824C (GUN METAL GRAY FINISH)

ITEM NO.	PART NUMBER	DESCRIPTION	QTY.
1	21-2113DK	AIR FILTER; 3.25" X 7" DRYFLOW	1
2	2-1568C	INTAKE TUBE; 3.25" X 23"L, 21-791; GUNMETAL GRAY	1
3	20-8601	HEAT SHIELD, LEXUS GS200T, 2017, TB/PC	1
4	9-0378	VENTURI; 3.075"OD X 2.975"ID X 3.25"L, PLASTIC	1
5	08476	HOSE; 2-1/2" TO 2-1/4" ID X 2" L TPRD REINFORCED	1
6	102472	EDGE TRIM; 3/4" BULB, TOP LOC, 66"L	1
7	444.460.04	NUT; M6 HEX SERRATED	1
8	08160	WASHER; 1"D X 1/4 HOLE FENDER	1
9	1228598	MOUNT, RUBBER 5/8" X 6MM	1
10	1-2110	BOLT; HEX/FLANGE M6-1.0 X 12	1
11	21685	WASHER; 1" X .300 X .100 RUBBER	1
12	07733	BOLT; M4 - 0.07 8MM, A/H CAP, SS	2
13	9452	1/2" BNDHOSE CLAMP,2.90"-3.75"	1
14	9436	1/2" BNDHOSE CLAMP,1.81"-2.75"	2



Read and understand these instructions **BEFORE** attempting to install this product. Failure to follow installation instructions and not using the provided hardware may damage the intake tube, throttle body and engine.

Tools Needed:	Optional:
Screwdriver	Socket Extensions
10mm Socket	Small Torque Wrench
Ratchet	
Pliers	
3mm Hex Key	

1. Preparing Vehicle

- Make sure vehicle is parked on level surface.
- Set the parking brake.
- If engine has run in the past two hours, let it cool down.
- Disconnect negative battery terminal.
- Do not discard stock components after removal of the factory system.
- Open the air intake kit package and make sure all parts are included.

2. Removal of stock system



a. Carefully pull up on engine cover and remove it.



b. Remove the [4] retainer clips by depressing the mandrel in the center. Then pull off the plastic shroud.



c. Unplug the Mass Air Flow (MAF) sensor harness and unclip it from the upper air box.



d. Remove the M6 bolt securing the factory intake tube.



e. Loosen the intake tube hose clamp and pull the PCV hose from the intake tube.



f. Undo the [4] airbox latches and remove the upper intake assembly.



g. Remove the [2] M6 bolts securing the lower airbox.



h. Flip the lower airbox around and unclip the MAF harness.



i. Remove the M6 bolt on the core support.



j. Remove the M6 bolt securing the ground cable bracket.



k. Remove the MAF sensor from the factory intake tube. Do not discard any factory components or hardware removed thus far.

3. Installation of AEM® intake system.

a. When installing the intake system, do not completely tighten the hose clamps or mounting hardware until instructed to do so.



a. Apply the supplied bulb seal trim to the heat shield as shown. Trim as necessary.



b. Insert the venturi into the intake tube. Be sure to align the pass-thru cutout in the venturi with the hole for the MAF sensor on the AEM intake tube.



c. Install the MAF sensor using the supplied M4 bolts.



d. Install the coupler with hose clamps onto the turbo inlet pipe. Make sure the smaller end of the coupler is ed to the turbo inlet side. Tighten the hose clamp on the turbo inlet side at this e.



e. Install the rubber mount, washer, and nut onto the bracket as shown. Leave the nut loose.



f. Place the rubber washer as shown.



g. Place the heat shield into the engine bay. Make sure the cold air scoop is properly aligned in the heat shield cut-out. Then secure with the supplied M6 bolt and the [2] M6 bolts removed in steps 2i & 2j.



h. Clip the MAF harness to the heatshield in the locations shown.



i. Insert the AEM intake tube into the turbo inlet coupler. Leave the hose clamp loose. Connect the PCV hose to the port on the intake tube.



j. Align the mounting bracket to the rubber mount. Position the tube for best fit, then tighten the nut. Also, tighten the hose clamp loose in previous step.



k. Reconnect the MAF harness.



l. Install the AEM air filter and tighten the hose clamp on the air intake tube.



m. Reinstall the plastic shroud with the [4] retainer clips. To reinstall the retainer clips: Pull the mandrel from the main clip, insert the clip into its respective location, and reinsert the mandrel.



n. Reinstall the engine cover. Make sure the grommets are fully seated.



STOCK INTAKE INSTALLED



AEM INTAKE INSTALLED

4. Reassemble Vehicle

- a. Position all kit components for best fitment. Ensure that no components contact any unintended part of the vehicle.
- b. Check for proper hood clearance. Re-adjust components if necessary and re-tighten them.
- c. Inspect the engine bay for any loose tools and ensure that all fasteners that were moved or removed are properly tightened.
- d. Reconnect negative battery terminal and start engine. Let the vehicle idle for 3 minutes. Perform a final inspection before driving the vehicle.

5. Service and Maintenance

- a. AEM Induction Systems requires cleaning the intake system's air filter element every 100,000 miles. When used in dusty or off-road environments, our filters will require cleaning more often. We recommend that you visually inspect your filter once every 25,000 miles to determine if the screen is still visible. When the screen is no longer visible some place on the filter element, it is time to clean it. To clean, purchase our Synthetic air filter cleaner, part number 1-1000 and follow the easy instructions.
- b. Use window cleaner to clean your powder coated AEM[®] intake tube.

NOTE: DO NOT USE aluminum polish on powder coated AEM[®] intake tubes.