



Equipped with AEM® Dryflow™ Filter  
No Oil Required!

# INSTALLATION INSTRUCTIONS

## PART NUMBER

### 21-819

---

2016	INFINITI	Q50	3.0TT
2017	INFINITI	Q60	3.0TT

ITEM NO.	PART NUMBER	DESCRIPTION	QTY.
1	21-2127DK	AIR FILTER; 2-3/4" X 5" OVAL DRYFLOW	2
2	20-8593	HEAT SHIELD; DS, 2016 INFINITI Q50 3.0TT, MLD STL, TB/PC	1
3	20-8594	HEAT SHIELD; PS, 2016 INFINITI Q50 3.0TT, MLD STL, TB/PC	1
4	7-362	BRACKET; MAF HOUSING, PS; 2016 INFINITI Q50 3.0TT, TB/PC	1
5	7-363	BRACKET; MAF HOUSING, DS; 2016 INFINITI Q50 3.0TT, TB/PC	1
6	102461	EDGE TRIM; 3/4" BULB, TOP LOC, 80"	1
7	8-186-1	MOUNT, PLASTIC AIRBOX, NYLON	2
8	1-2110	BOLT; HEX/FLANGE M6-1.0 X 12	2
9	444.460.04	NUT; M6 HEX SERRATED	4
10	08601K	HOSE CLAMP; #48, BLACK ZINC PLATED	2

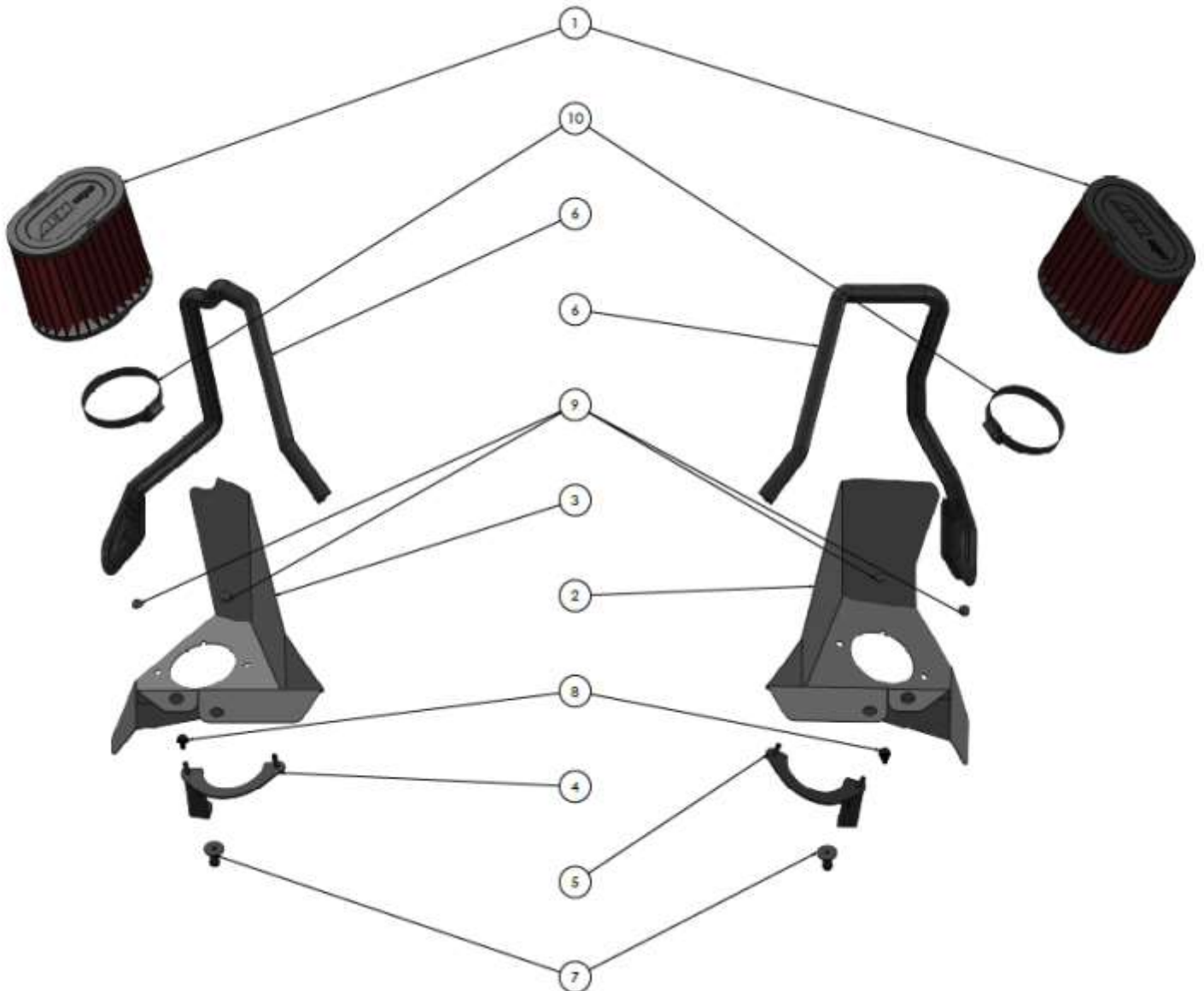

Read and understand these instructions **BEFORE** attempting to install this product. Failure to follow installation instructions and not using the provided hardware may damage the intake tube, throttle body and engine.

Tools Needed:	Optional:
Screwdrivers	Small Torque
8mm, 10mm	Wrench
Socket	
Ratchet	
12mm Open	
Wrench	

## 1. Preparing Vehicle

- Make sure vehicle is parked on level surface.
- Set the parking brake.
- If engine has run in the past two hours, let it cool down.
- Disconnect negative battery terminal.
- Do not discard stock components after removal of the factory system.
- Open the air intake kit package and make sure all parts are included.

## 2. Removal of stock system



a. Use a small flat head screwdriver to remove the 8 push-in clips shown. Then, pull off the factory radiator shroud/cold air duct.



b. Remove the 4 bolts securing the factory air boxes.



c. Unlatch the forward half of the factory air box and remove it. Also remove the air filter. Do not discard any factory components/hardware.



d. Unclip the mass airflow (MAF) harness from the rearward half of the factory air box. Then, disconnect the harness from the sensor itself.



e. Use a long head screwdriver to disengage the retaining clip as shown. This will allow you to separate the MAF housing and air box from the turbo inlet hose.  
**NOTE: The retaining clip must be FULLY disengaged from the MAF housing to allow for separation. Minimal force is required to do this. Do not forcefully pull or pry on the MAF housing or clip, or damage may occur.**



g. Remove the 2 screws that hold the MAF housing to the air box. Then separate the MAF housing from the air box. Set the o-rings aside, they will not be reused.



f. Repeat steps 2c, d, & e for the opposite side of the vehicle.



h. Remove the grommet and sleeve from the forward half of the factory air box. Do this for both air boxes. You will reuse these components in step 3a.



i. Remove the bracket shown and replace the grommet into the hole in the frame rail (circled above).

### 3. Installation of AEM® intake system.

- a. When installing the intake system, do not completely tighten the hose clamps or mounting hardware until instructed to do so.



a. Apply edge trim to both heat shields as shown. Cut the single 80" length of trim as necessary. Also install the grommets and sleeves removed in step 2h.



b. Assemble both MAF housing brackets as shown.



c. Assemble the driver side intake system as shown. Take care to use the correct MAF housing bracket (part number "7-363" will be stamped on).



d. Assemble the passenger side intake system as shown. Take care to use the correct MAF housing bracket (part number "7-362" will be stamped on).



e. Install the air filter with the supplied hose clamp to the driver side intake system as shown. Then tighten the hose clamp to 30 in-lbs.



f. Install the air filter with the supplied hose clamp to the passenger side intake system as shown. Then tighten the hose clamp to 30 in-lbs.



g. Place the driver side intake system into the engine bay. Reconnect the MAF harness to the sensor. Insert the MAF housing into the turbo inlet hose. Make sure the retaining clip snaps back into engagement. Then push down on the heatshield until you feel the plastic stud seat into the grommet in the frame rail. Secure to upper core support with one of the factory bolts removed in step 2b.



h. Repeat previous step for passenger side. Then reinstall the factory radiator shroud/cold air duct.



STOCK INTAKE INSTALLED



AEM INTAKE INSTALLED

#### 4. Reassemble Vehicle

- a. Position all kit components for best fitment. Ensure that no components contact any unintended part of the vehicle.
- b. Check for proper hood clearance. Re-adjust components if necessary and re-tighten them.
- c. Inspect the engine bay for any loose tools and ensure that all fasteners that were moved or removed are properly tightened.
- d. Reconnect negative battery terminal and start engine. Let the vehicle idle for 3 minutes. Perform a final inspection before driving the vehicle.

#### 5. Service and Maintenance

- a. AEM Induction Systems requires cleaning the intake system's air filter element every 100,000 miles. When used in dusty or off-road environments, our filters will require cleaning more often. We recommend that you visually inspect your filter once every 25,000 miles to determine if the screen is still visible. When the screen is no longer visible some place on the filter element, it is time to clean it. To clean, purchase our Synthetic air filter cleaner, part number 1-1000 and follow the easy instructions.
- b. Use window cleaner to clean your powder coated AEM<sup>®</sup> intake tube.

**NOTE: DO NOT USE aluminum polish on powder coated AEM<sup>®</sup> intake tubes.**