



Equipped with AEM® Dryflow™ Filter
No Oil Required!

INSTALLATION INSTRUCTIONS
PART NUMBER
21-818C (GUN METAL GRAY FINISH)

2017

Nissan

Sentra SR Turbo

1.6T

ITEM NO.	PART NUMBER	DESCRIPTION	QTY.
1	21-2157DK	AIR FILTER 2-3/4" FLG, 5-1/2"B, 4-3/4T DRYFLOW	1
2	2-1599C	INTAKE TUBE; 2.75"OD X 18", 21-818 UPR, GUNMETAL GRAY	1
3	2-1600C	INTAKE TUBE; 2.75"OD X 18", 21-818 LWR, GUNMETAL GRAY	1
4	9-0380	VENTURI; 2.6"OD X 2.4"ID X 4.0"L, PLASTIC	1
5	5-272	HOSE, SILICONE 2.75X2" BLACK	1
6	22224	BOLT; M6X1.00X12 HEX; FLG, GRADE 10.9, GEO	2
7	08160	WASHER; 1"D X 1/4 HOLE FENDER	2
8	9440	HOSE CLAMP, 2.15-3.00"	2
9	9444	HOSE CLAMP, 2.31-3.25"	1

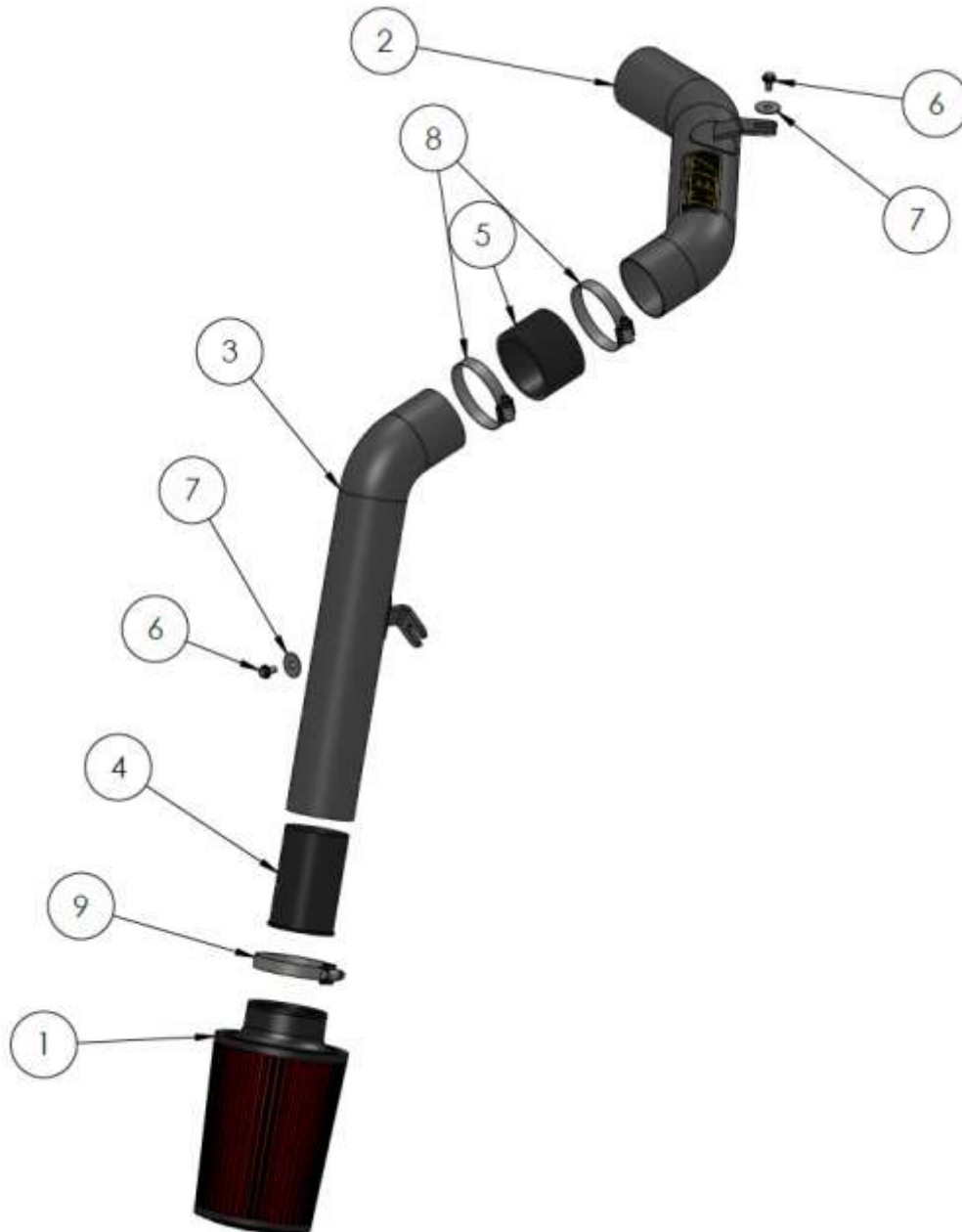

Read and understand these instructions **BEFORE** attempting to install this product. Failure to follow installation instructions and not using the provided hardware may damage the intake tube, throttle body and engine.

Tools Needed:	Needle Nose Pliers
Screwdrivers	Optional:
10mm Socket	Small Torque Wrench
Short Extension	
Socket Driver	
10mm Wrench	

1. Preparing Vehicle

- Make sure vehicle is parked on level surface.
- Set the parking brake.
- If engine has run in the past two hours, let it cool down.
- Disconnect negative battery terminal.
- Do not discard stock components after removal of the factory system.
- Open the air intake kit package and make sure all parts are included.

2. Removal of stock system



a. Push the plastic tab on the air box resonator so it is unclipped.



b. Lift the resonator duct up and out of the engine bay. Pull gently to release it from the grommet.



c. Unlatch the two clips on the air box and remove the forward section of the air box and the air filter from the engine bay.



d. Remove the bolt securing the air box to the metal bracket.



e. Disconnect the Mass Air Flow (MAF) sensor harness. Release the harness from the air box using pliers as shown.



f. Loosen the hose clamp securing the factory coupler to the air box.



g. Pull up on the air box to release it from its grommets, disconnect the coupler, and turn the box on its side as shown to access the next wire. Release the harness from the air box and remove the air box from the engine bay.



h. Release the metal wire from the metal bracket as show and move the MAF harness down and out of the way.



i. Remove the three grommets from the engine bay and store them on the air box for safe keeping. They will not be reused.



j. Use the next picture to help in removal of the intake resonator indicated in this step. Both bolts are accessible from above using a ratchet, socket, and extension.



k. The positions of the two bolts from step 2j as seen from the front of the car are shown by the arrows. The left-hand side bolt will require a short extension. Allow the resonator to fall to the bottom of the bumper area once both bolts are removed.



l. Lift the front of the car with a jack and turn the wheels to the left. **Note: Support car with jack stands once lifted.**



m. Remove the 4 plastic push-in clips in the fender well area indicated. The ABS wire will need to be moved for access (black arrow).



n. Remove the three bolts securing the front of the inner fender liner.

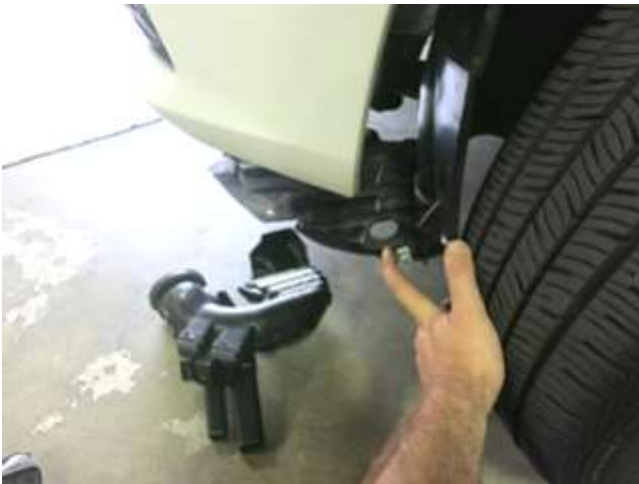

o. Pull back the inner fender liner to remove the stock intake resonator. **Note: Do not discard any of your stock equipment.**



p. Remove the MAF sensor from the factory air box. The MAF sensor and screws will be reused in step 3b.

3. Installation of AEM® intake system.

a. When installing the intake system, do not completely tighten the hose clamps or mounting hardware until instructed to do so.



a. Align the hole in the venturi insert with the MAF pad as shown and fully insert into the lower intake tube. **Note: The venturi insert is necessary for proper engine function and performance.**



b. Install the MAF sensor into the lower intake tube using the screws removed in step 2p.



c. Connect the upper intake tube to the factory coupler. Soapy water can be used to help install. Tighten this hose clamp at this time.



d. Loosely secure the upper intake tube to the factory metal bracket using the provided bolt and washer.



e. Install the provided coupler and hose clamps on to the upper intake tube. Position the coupler so it overlaps the upper intake tube about 1 inch and tighten the upper hose clamp.



f. Bring the lower intake tube into the engine bay from under the fender well area and insert it into the coupler. Use care not to scratch the finish on your new intake tube. Masking tape can be used on the sharp edge of the core support if necessary. Do not fully tighten the lower hose clamp at this time.



g. Loosely secure the lower intake tube to the inner fender using the bolt and washer provided.



h. Install the AEM Dry Flow filter onto the lower intake tube with the provided hose clamp. Reconnect the MAF harness to the sensor and ensure the harness is not pinched where it is routed. Position the intake tubes for best fit and tighten the two bracket bolts and the final hose clamp. The tube is rigidly mounted to the chassis, so fit clearances are ok. The factory coupler will allow for engine movements. Reassemble the inner fender liner and ensure the ABS wire is secured back into its bracket before lowering the car.



STOCK INTAKE INSTALLED



AEM INTAKE INSTALLED

4. Reassemble Vehicle

- a. Position all kit components for best fitment. Ensure that no components contact any unintended part of the vehicle.
- b. Check for proper hood clearance. Re-adjust components if necessary and re-tighten them.
- c. Inspect the engine bay for any loose tools and ensure that all fasteners that were moved or removed are properly tightened.
- d. Reconnect negative battery terminal and start engine. Let the vehicle idle for 3 minutes. Perform a final inspection before driving the vehicle.

5. Service and Maintenance

- a. AEM Induction Systems requires cleaning the intake system's air filter element every 100,000 miles. When used in dusty or off-road environments, our filters will require cleaning more often. We recommend that you visually inspect your filter once every 25,000 miles to determine if the screen is still visible. When the screen is no longer visible some place on the filter element, it is time to clean it. To clean, purchase our Synthetic air filter cleaner, part number 1-1000 and follow the easy instructions.
- b. Use window cleaner to clean your powder coated AEM[®] intake tube.

NOTE: DO NOT USE aluminum polish on powder coated AEM[®] intake tubes.