



Equipped with AEM® Dryflow™ Filter
No Oil Required!

INSTALLATION INSTRUCTIONS
PART NUMBER
21-797C (GUN METAL GRAY FINISH)

2016

VW

Jetta

1.4T

ITEM NO.	PART NUMBER	DESCRIPTION	QTY.
1	2-1578C	TUBE; 3.25"D X 24.5"L, AL, 2016 VW JETTA 1.4T	1
2	21-2113DK	AIR FILTER; 3.25" X 7" DRYFLOW	1
3	20-8584	HEAT SHIELD; 2016 VW JETTA 1.4T	1
4	102470	EDGE TRIM; 3/4 BULB, TOP LOC, 57"L	1
5	5-1096	COUPLER; 3.125"ID X 2.375"ID, 64DEG	1
6	08064	GROMMET; 1"OD,1/2"ID,1/2"THK	2
7	345003	SPRING CLAMP; FBS, 15MM/12M	1
8	08554K	HOSE CLAMP #40, BLACK ZINC PLATED	1
9	08620K	HOSE CLAMP #56, BLACK ZINC PLATED	2
10	1-2110	BOLT; HEX/FLANGE M6-1.0 X 12	1

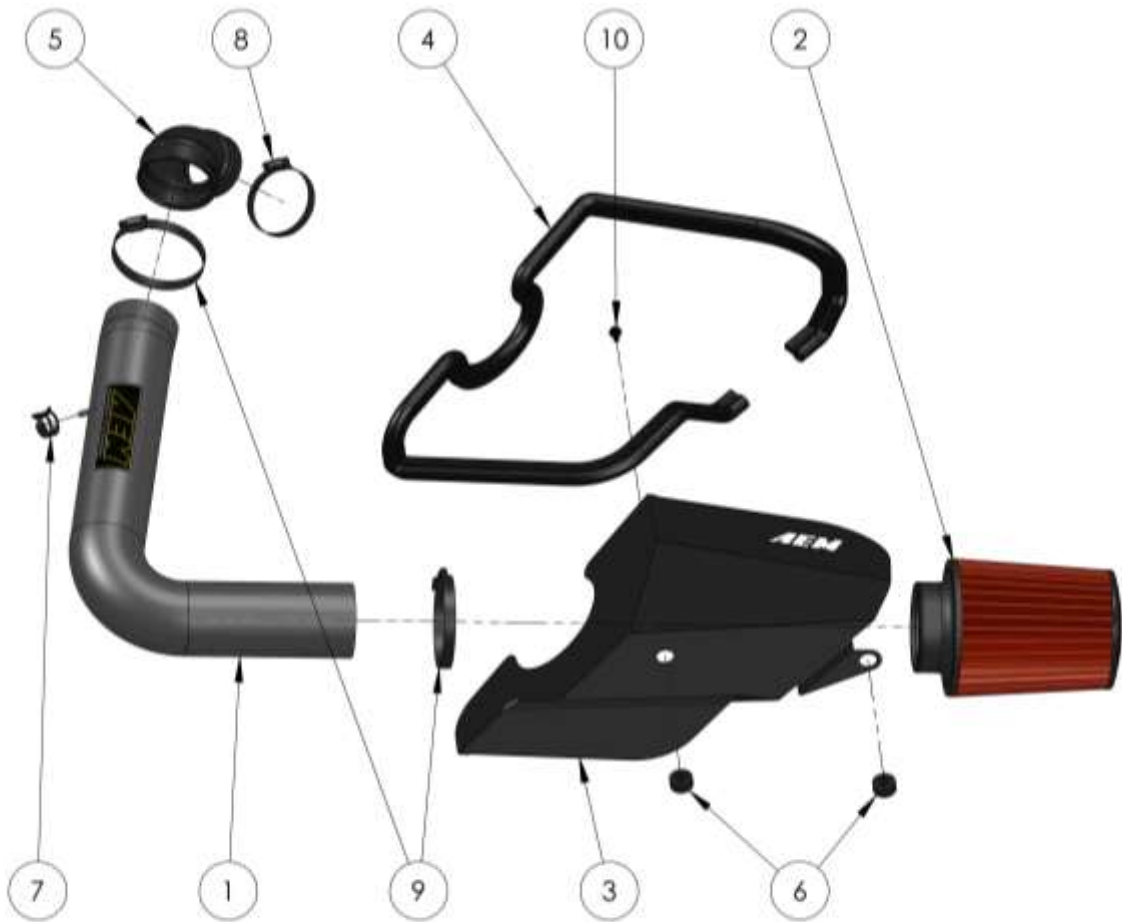

Read and understand these instructions **BEFORE** attempting to install this product. Failure to follow installation instructions and not using the provided hardware may damage the intake tube, throttle body and engine.

Tools Needed:	Optional:
T20 Torx Key	Small Torque Wrench
8mm Socket	Soapy Water
Socket Driver	
Long-nose Pliers	
Flat Screwdriver	
Utility Knife	

1. Preparing Vehicle

- a. Make sure vehicle is parked on level surface.
- b. Set the parking brake.
- c. If engine has run in the past two hours, let it cool down.
- d. Disconnect negative battery terminal.
- e. Do not discard stock components after removal of the factory system.
- f. Open the air intake kit package and make sure all parts are included.

2. Removal of Factory System



a. Use a T20 Torx key to remove the two screws securing the factory fresh air inlet to the radiator core support.



b. Use long-nose pliers to disengage the spring clamp securing the factory plumbing to the turbo inlet. Slide the spring clamp up & away from the end of the tube portion. Pull the tube portion up & off of the turbo inlet.



c. Pull the vent hose off of the back of the air box (upper arrow). The factory plumbing can now be removed by placing one hand as shown and the other according to the lower arrow above & lifting firmly straight up.



d. Once the air box is removed, use a screwdriver to pry one of the rubber mounts out of the air box taking care to not puncture or tear the grommet.

3. Installation of AEM® intake system.

- a. When installing the intake system, do not completely tighten the hose clamps or mounting hardware until instructed to do so.



a. Install the small end of included coupler with it's corresponding hose clamps on each end (refer to diagram on pg2). Using soapy water as a lubricant is helpful.



b. Assemble the heat shield assembly including the edge trim & grommets as shown in the diagram on pg 2 & install as shown. Cut off excess trim if necessary.



c. Secure the heat shield with the included M6 bolt.



d. Press the factory grommet removed in step 2d into the stand-off on the bottom of your new AEM intake tube. Again, using soapy water as a lubricant may be helpful.



e. Lower the tube into position. Press down firmly to engage the rubber mount onto the factory mount location.



f. Position the air filter along with the final hose clamp onto the tube. Once the tube is aligned and the coupler and air filter are both fully engaged, you may tighten all three hose clamps to 30 in-lbs.



g. Install the vent hose onto the tube with the included spring clamp.



STOCK INTAKE INSTALLED



AEM INTAKE INSTALLED

4. Reassemble Vehicle

- a. Ensure that all kit components are positioned for best fitment and that no components contact any unintended part of the vehicle.
- b. Check for proper hood clearance. Re-adjust components if necessary and re-tighten them.
- c. Inspect the engine bay for any loose tools and ensured that all fasteners that were moved or removed are properly tightened.
- d. Reconnect negative battery terminal and start engine. Let the vehicle idle for 3 minutes. Perform a final inspection before driving the vehicle.

5. Service and Maintenance

- a. AEM Induction Systems requires cleaning the intake system's air filter element every 100,000 miles. When used in dusty or off-road environments, our filters will require cleaning more often. We recommend that you visually inspect your filter once every 25,000 miles to determine if the screen is still visible. When the screen is no longer visible some place on the filter element, it is time to clean it. To clean, purchase our Synthetic air filter cleaner, part number 1-1000 and follow the easy instructions.
- b. Use window cleaner to clean your powder coated AEM[®] intake tube.

NOTE: DO NOT USE aluminum polish on powder coated AEM[®] intake tubes.