



Equipped with AEM® Dryflow™ Filter  
No Oil Required!

**INSTALLATION INSTRUCTIONS**  
**PART NUMBER**  
**AEM-21-787C (GUN METAL GRAY FINISH)**

---

2015-16

LEXUS

NX200T

2.0L

ITEM NO.	PART NUMBER	DESCRIPTION	QTY.
1	9436	1/2" BNDHOSE CLAMP,1.81"-2.75"	2
2	08476	HOSE; 2-1/2" TO 2-1/4" ID X 2" L	1
3	2-1565C	TUBE; AL , 21-787, GUNMETAL GRAY	1
4	102472	EDGE TRIM; 3/4"BULB, TOP LOC, 66"L	1
5	1-2051	BOLT; BTN HD M4-0.7 X 6MM	2
6	9-0378	VENTURI; PLASTIC	1
7	9452	1/2" BNDHOSE CLAMP,2.90"-3.75"	1
8	08657	HOSE; HUMP;3.25 ID- 3.5 ID; BLK; EPDM; 50	1
9	9456	1/2" BNDHOSE CLAMP,3.15"-4.00"	1
10	07730	BOLT; M6 X 1.00 X 16MM , BUTTONHEAD, SS	3
11	1-3025	WASHER, M6 SPLIT LOCK ZINC	3
12	08275	WASHER; 1/4"ID X 5/8"OD - SAE	3
13	8-186-1	MOUNT, PLASTIC AIRBOX, NYLON	1
14	20-8571B	HEAT SHIELD, LEXUS NX200 2.0L 2015, TB/PC	1
15	21512-1	ADAPTER; UNIVERSAL, 6" FILTER 3.5" COUPLER	1
16	94104	1/2" BNDHOSE CLAMP,4.125-7.00"	1
17	21-210EDK	AIR FILTER; 6" X 6" DRYFLOW	1
18	784632	GROMMET,7/16"	1

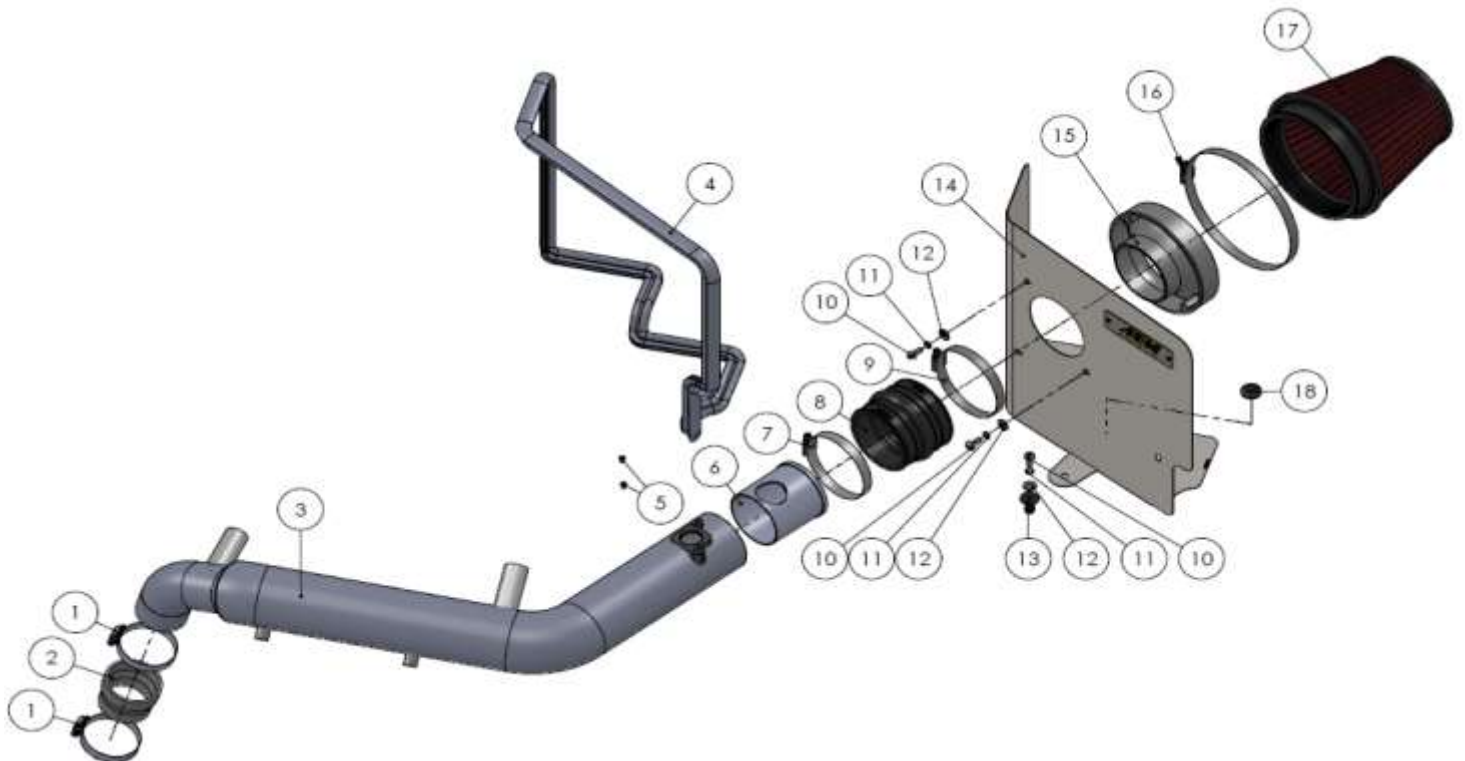

Read and understand these instructions **BEFORE** attempting to install this product. Failure to follow installation instructions and not using the provided hardware may damage the intake tube, throttle body and engine.

## 1. Preparing Vehicle

- a. Make sure vehicle is parked on level surface.
- b. Set the parking brake.
- c. If engine has run in the past two hours, let it cool down.
- d. Disconnect negative battery terminal.
- e. Do not discard stock components after removal of the factory system.
- f. Open the air intake kit package and make sure all parts are included.

### Tools Needed:

Phillips Screw Driver  
8 & 10mm Socket  
Swivel Extension  
Socket Driver  
Pliers  
2.5 & 4mm Hex Key  
Cutting Blade

## 2. Removal of stock system



a. Loosen the hose clamp at the air box.



b. Squeeze to loosen the spring clamps and disconnect the vent hoses from the stock intake tube.



c. Loosen and remove the two bolts securing the stock intake tube to the vehicle.



d. Loosen the hose clamp at the turbo compressor inlet.





e. Slide the hose out of the clips that hold it on the stock intake tube.



f. Remove the stock intake tube from the vehicle.



g. Depress the clip and remove the mass air flow (MAF) sensor connector from the sensor.



h. Slide the wire loom clip off of the air box.



i. Unlatch the two clips that hold the upper air box to the lower air box and remove the upper air box.



j. Remove the stock air filter from the lower air box.



k. Remove the two bolts securing the lower air box to the vehicle. One bolt will be reused in step 3s.



l. Maneuver the lower air box to access the three push-in wire harness clips and disconnect all of them.



m. Remove the lower air box from the vehicle. **Note:** Do not discard any of your stock equipment.



n. Turn the lower air box over and remove one of the metal sleeves and rubber grommet. The metal sleeve will be reused in step 3E.



o. Remove the two screws that secure the MAF sensor to the upper air box. The MAF sensor will be reused in step 3b.



p. Remove the two bolts and stand offs. These will be reused in step 3c.



### 3. Installation of AEM<sup>®</sup> intake system.

- a. When installing the intake system, do not completely tighten the hose clamps or mounting hardware until instructed to do so.



a. Install the venturi into the AEM intake tube, be sure the two openings are aligned.



b. Install the MAF sensor into the AEM intake tube and secure with the provided hardware.



c. Take the stand-offs and bolts from step 2p. and install the bolts according to the inset picture. Then, install them onto the AEM intake tube as shown.



d. Install the edge trim as shown around the AEM heat shield, trim off excess if necessary. Then, install the provided grommet into the hole shown.



e. Take the sleeve that was removed in step 2n and install it into the grommet. **Note: A little soapy water will ease installation.**



f. Assemble the adapter and air box mount with the provided hardware according to diagram on pg. 2.



g. Install the hump hose onto the adapter with the provided hose clamps. Tighten the hose clamp closest to the heat shield at this time.



h. Install the hose and hose clamps onto the turbo compressor inlet. Tighten the hose clamp closest to the turbo at this time.



i. Secure the MAF sensor wiring harness onto the AEM heat shield via the stock clips. Then, lower the heat shield into the engine bay and press the air box mount into the stock grommet.



j. Align the grommet/sleeve with the mounting hole in the vehicle and use the factory bolt removed in step 2k to secure the heat shield to the vehicle.





k. Install the AEM intake tube into the vehicle aligning the tube with the previously installed hoses.



l. Install the vent hoses onto the AEM intake tube and secure with the spring clamps removed in step 2b.



m. Tighten the hose clamps at the turbo compressor and heat shield securing the AEM intake to the hoses.



n. Plug the MAF sensor connector into the MAF sensor.



o. Install the AEM filter onto the filter adapter and tighten the hose clamp.



p. Place the hose back into the clips that were removed in step 2e.





STOCK INTAKE INSTALLED



AEM INTAKE INSTALLED

#### 4. Reassemble Vehicle

- a. Position all kit components for best fitment. Ensure that no components contact any unintended part of the vehicle.
- b. Check for proper hood clearance. Re-adjust components if necessary and re-tighten them.
- c. Inspect the engine bay for any loose tools and ensure that all fasteners that were moved or removed are properly tightened.
- d. Reconnect negative battery terminal and start engine. Let the vehicle idle for 3 minutes. Perform a final inspection before driving the vehicle.

#### 5. Service and Maintenance

- a. AEM Induction Systems requires cleaning the intake system's air filter element every 100,000 miles. When used in dusty or off-road environments, our filters will require cleaning more often. We recommend that you visually inspect your filter once every 25,000 miles to determine if the screen is still visible. When the screen is no longer visible some place on the filter element, it is time to clean it. To clean, purchase our Synthetic air filter cleaner, part number 1-1000 and follow the easy instructions.
- b. Use window cleaner to clean your powder coated AEM<sup>®</sup> intake tube.

**NOTE: DO NOT USE aluminum polish on powder coated AEM<sup>®</sup> intake tubes.**