



Stylish & Economical Roll-Up Cover



INSTALLATION INSTRUCTIONS AND OWNER'S MANUAL

Thank you for purchasing an ACCESS® TONNOSPORT™ Cover. ACI has manufactured this roll-up cover with pride using superior quality materials and craftsmanship. With proper care, your cover will provide years of service and enjoyment.

NOTICE TO INSTALLER: It is recommended you take the time to read these instructions before installing this cover even if already familiar with the product. Often improvements are made without prior notice. Always handle cover and components with care to avoid damage. If you find a part missing or defective, or if you are having trouble installing this product, please have serial number ready (found on decal under rear bar by tailgate) and call the customer service number on the back page. **When done, these instructions and warranty information must be given to the consumer.**

NOTICE TO CONSUMER: Before using this product, read the operating instructions, maintenance and safety sections of this owners manual and save for future reference.

PARTS KEY

Driver Side

rear

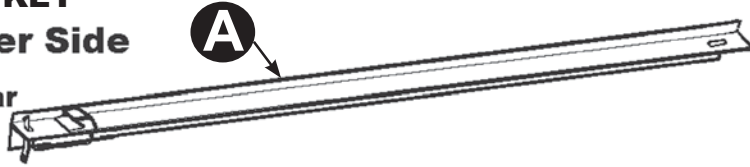

Passenger Side

rear

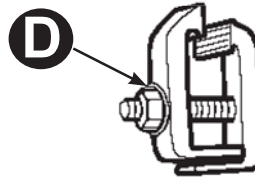
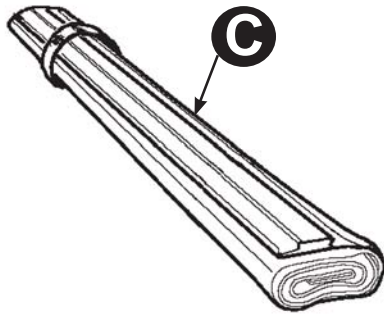
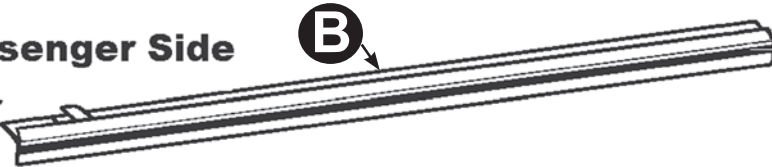

6X

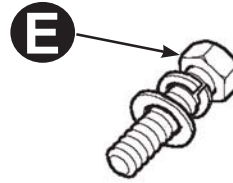

2X

TOOLS NEEDED



1/2"



9/16"



(2X)

NOTE ON BED LINERS: With an under-the-rail drop in bed liner, installation is possible with minimal trim cutting of bed liner at front corner of box and back by tailgate to allow side rail to install properly. Considerable trim cutting is required with an over-the-rail drop in bed liner.

INSTALLATION INSTRUCTIONS:

(NOTE: For additional installation assistance visit us at tonnosport.com)

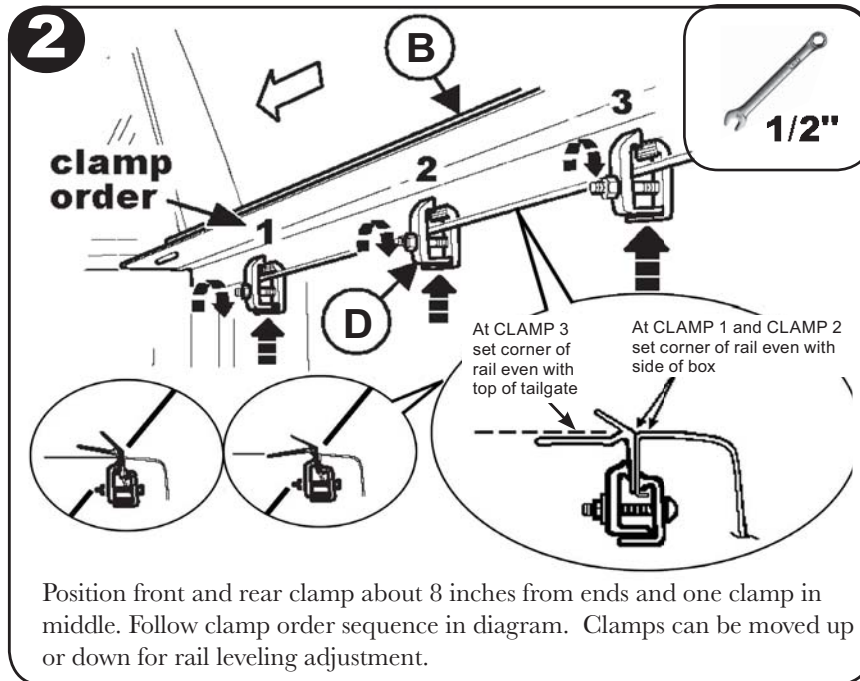
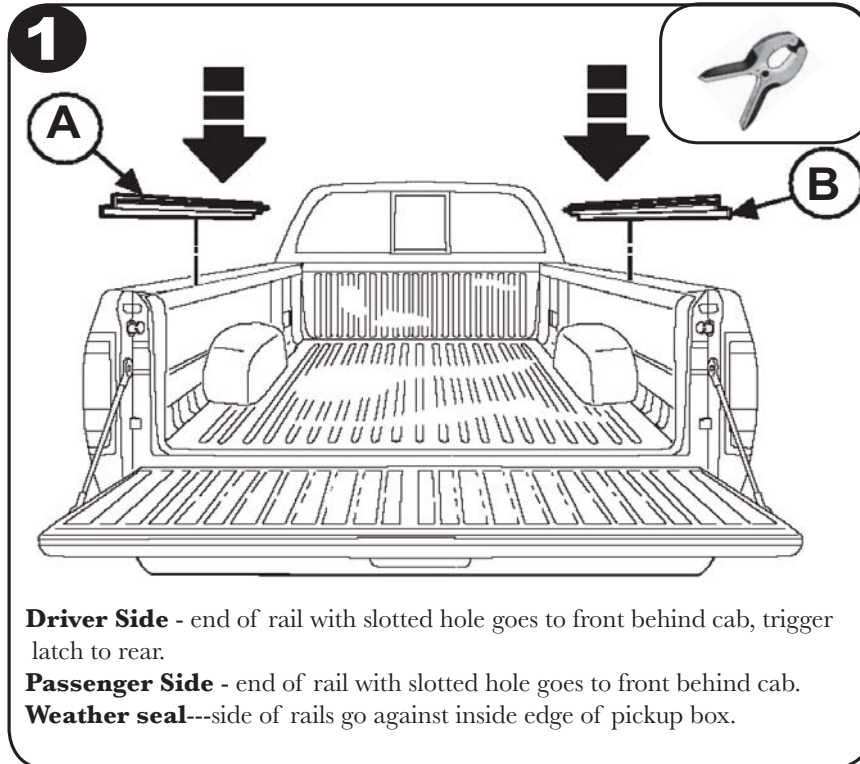

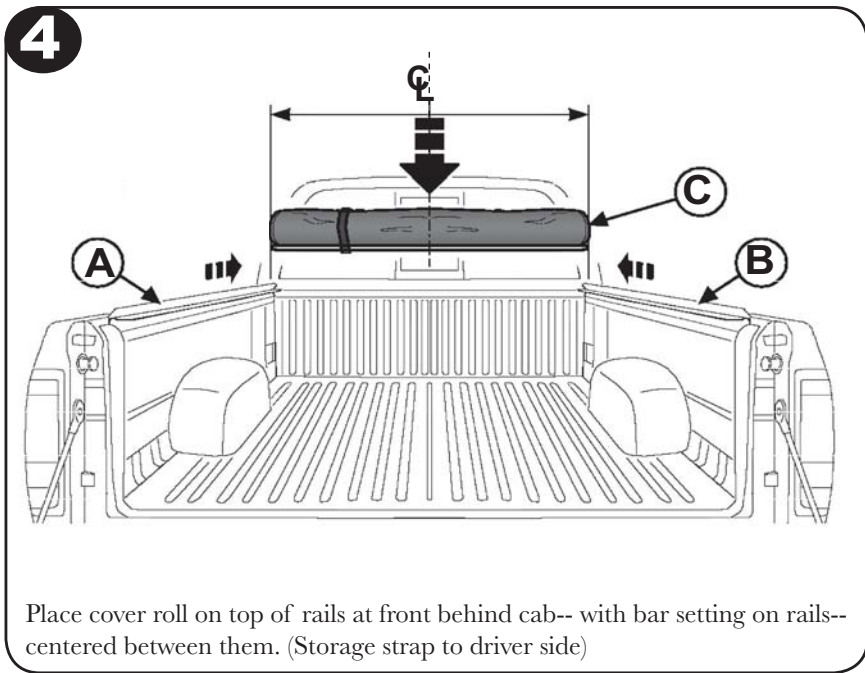
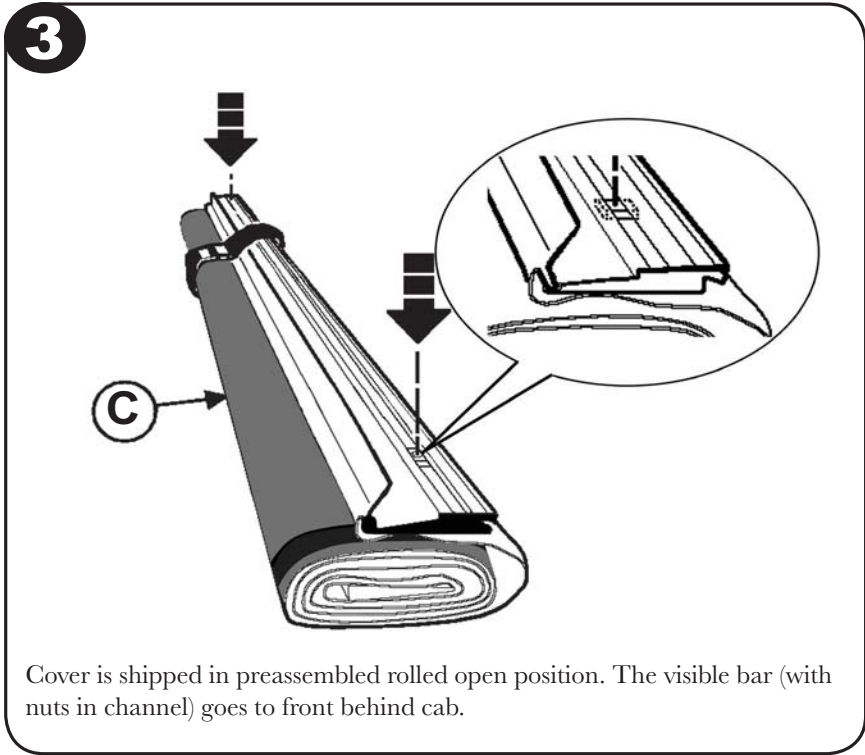

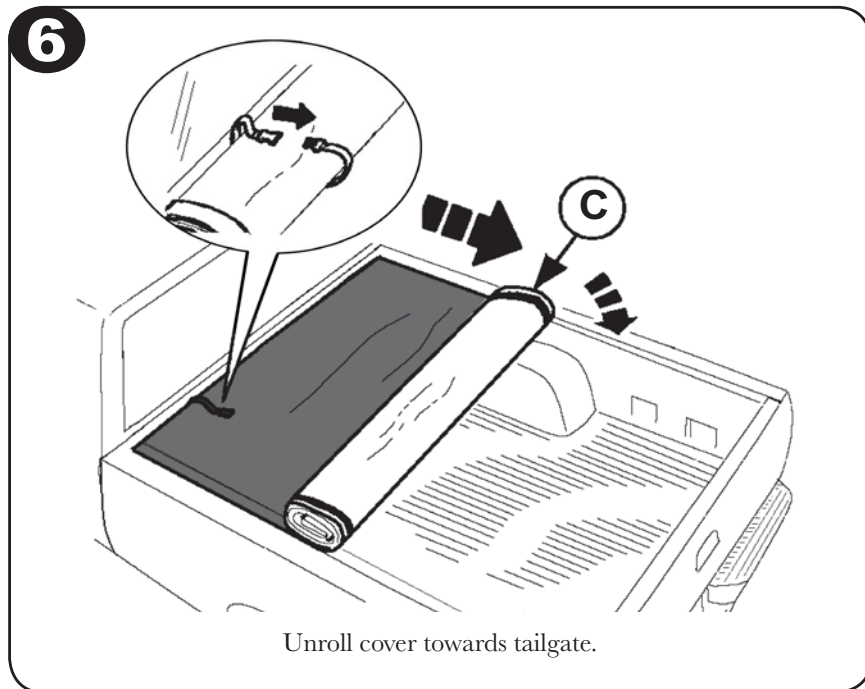
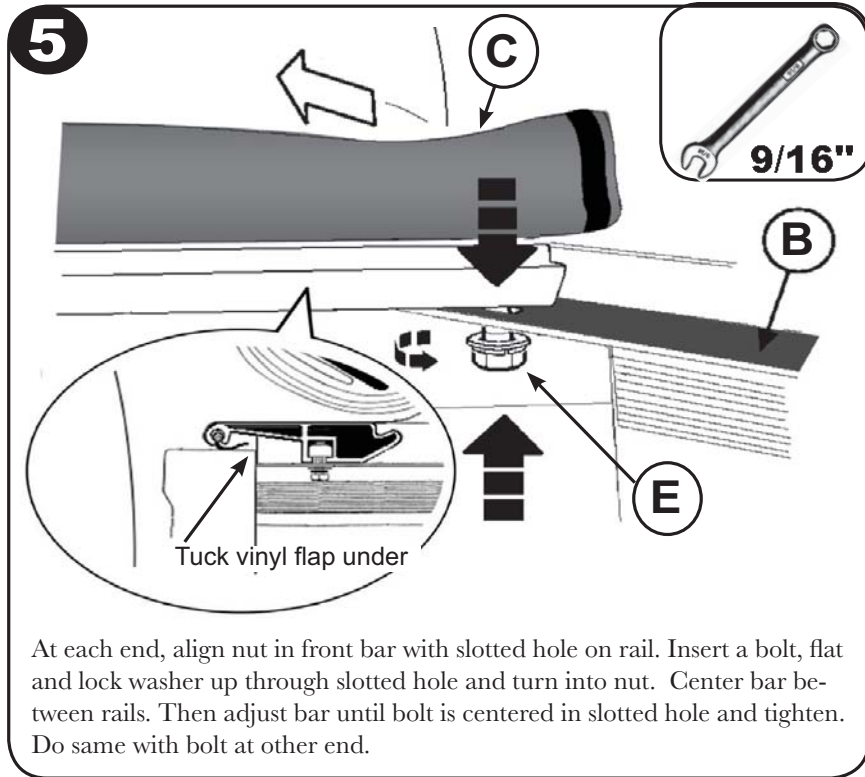

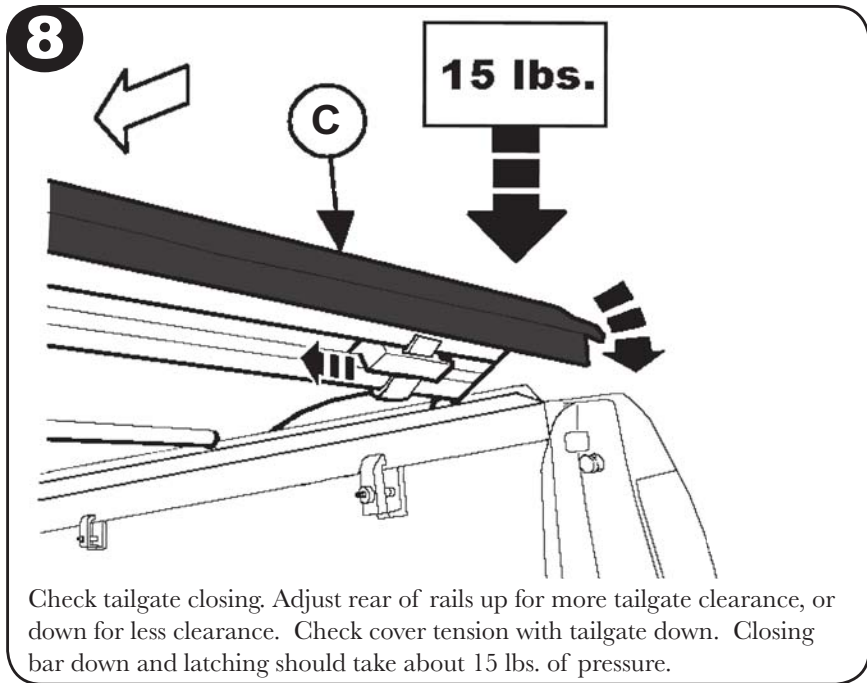
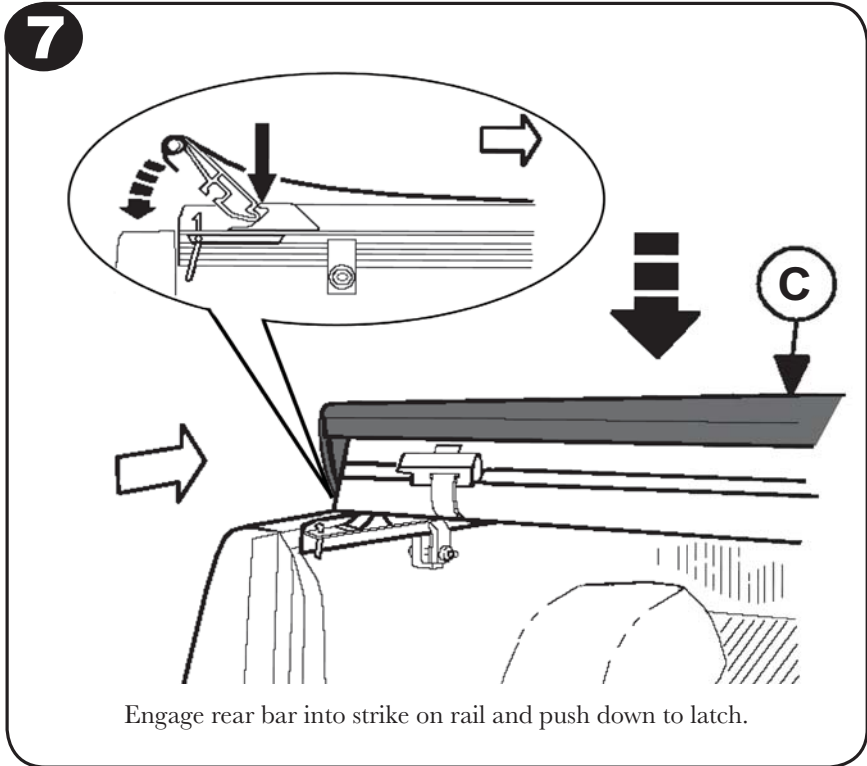

9

9/16"

- To **adjust** tension, roll cover open, loosen each bolt under front bar.
- To **increase** tension push each end of bar toward CAB about 1/16-1/8 inch at a time. Tighten bolts and close cover to check tension. Repeat if needed.
- To **decrease** tension, push each end of bar away from CAB about 1/16-1/8 inch at a time. Tighten bolts and close cover to check tension. Repeat if needed.
- On occasion, it may be necessary to set one end of front bar slightly forward of opposite end. Doing this will swing rear of cover to one side or other. This adjusts cover for better fit at tailgate.

10

For extra locking protection, push slide lock until engaged under rail on both passenger and driver sides.

Seal hook and loop on both sides to fully close cover.

OPENING/CLOSING THE COVER

OPENING FROM CLOSED POSITION



CLOSING FROM OPEN POSITION

- Release the storage strap and roll cover toward tailgate
- Position the roll-up bar against the strikes. Push down on bar until secure
Optional - push slide lock(s) into place
- Seal hook and loop on sides of the cover

SAFETY INFORMATION

- Do not cover cargo that is higher than the cover.
- Do not place object(s) on or against the cover or its framework at any time
- Always secure cargo so it cannot shift and damage the cover or its parts.
- Do not use the covers framework to tie down cargo.
- Never stand, sit or ride on the cover or allow others to do so.
- Do not leave valuables in an unattended vehicle as cover does not prevent theft of contents in truck box.
- The cover does not eliminate moisture and dust from entering the truck box. Special wrappings or packaging of the contents may be necessary.
- Due to poor ventilation, if you allow a pet/animal in the box, leave cover open. Do not allow people or animals to occupy box with the cover closed.
- When towing vehicle backwards, cover must be rolled fully open and secured with safety straps or fully closed and secured with manual slide lock.
- ALWAYS finish securing the cover. Use caution when operating cover in windy conditions.
- Periodically check and/or retighten clamp bolts as needed.
- Periodically check and/or retighten front bar tensioning bolts as needed.

TROUBLESHOOTING

PROBLEM	SOLUTION
Cover too loose	Loosen bolts under front bar and move bar forward. Retighten bolts
Cover too tight	Loosen bolts under front bar and move bar rearward. Retighten bolts
Gap between roll-up bar and tailgate	Rails set too high (Refer to #2)
Cover is too wide ...too narrow	Check rails. Rails in - too wide - push all clamps to top of rail Rails out - too narrow - pull all clamps down on rail (Refer to #2)
Lopsided cover too much on one side	Check front bar. It must be centered side to side (Refer to #4)
Top of tailgate hits rear bar when attempting to close	Raise side rails at rear of box until tailgate closes without pushing rear bar up (Refer to #2)
Manual slide locks too loose or too tight	Use 1/8" allen wrench and adjust set screw tighter or looser as desired. Lock performs best with some friction (Refer to #10)

INSPECTION, MAINTENANCE & TIPS (FOR A LONGER LASTING COVER)

- Inspection and much of the maintenance can be done by the operator. It may be necessary to review the installation and operating instructions.
- Periodically inspect the cover assembly. Check for loose bolts and parts and then tighten if needed. Test the operation to ensure that the parts are functioning properly and that the cover is in top operational condition.
- If latch has been damaged replace with new one. NOTE: Inspection and/or maintenance should also be performed anytime a malfunction is observed or suspected. If you need assistance inspecting and/or servicing your cover, or if you want to order a replacement part, call the customer service number listed in the warranty. Always use original equipment replacement parts for your cover.
- Vinyl cover can be treated with water based protectants. Avoid silicon based products.
- When cleaning, for best results use mild liquid soap and water. Never clean with petroleum or citrus based products.
- Always keep cover closed when not in use.
- Keep hook and loop sealed when cover is closed.
- Keep the cover tight, cover vinyl should sound drum-like when tapped on.
- Engage manually operated slide locks while traveling and before entering drive-through car washes.
- Avoid storing cover in its rolled-up position for long periods of time.
- Avoid allowing cargo to rub against cover while transporting, whether in open or closed position.